

PUSH-IN FITTINGS

GENERAL INTRODUCTION

Push-in fittings by Metal Work are the best elements for connecting pipes and actuators.

Quick and easy to use, the Metal Work push-in fitting can be re-used thousands of times without affecting the pneumatic and mechanical seal in any way. It comes in various configurations and guarantees a virtually unlimited, highly flexible use. The clamping spring with its special shape grips the pipe without scratching or deforming it.

These fittings are designed to facilitate pipe release. You only need to press the release bushing to open up the clamping spring and free the pipe. When you press your finger onto the release bushing, you can clearly hear the characteristic "click-clock" sound.

In the fittings, the release bushing has patented screwdriver slots to facilitate release in applications not accessible to the fingers.

Configurations RL19, RL21, RL22, RL23, RL23M, RL24, RL44, and RL49 (except for Ø5), have a ring for fixing to the wall asymmetrically in order to contain the head of a screw within the overall dimensions of the fitting. There are push-in fittings for metric pipes in the diameter range of 3 to 14, and push-in fittings for inch pipes in the diameter range of 1/8 to 1/2.

Threaded connections have ISO 228-1G cylindrical thread in the 1/8-1/2 range, ISO 7-1 conical thread in the 1/8-1/2 range, metric thread in the M3 to M12x1.5 range, and conical thread compatible with NPT female threading.

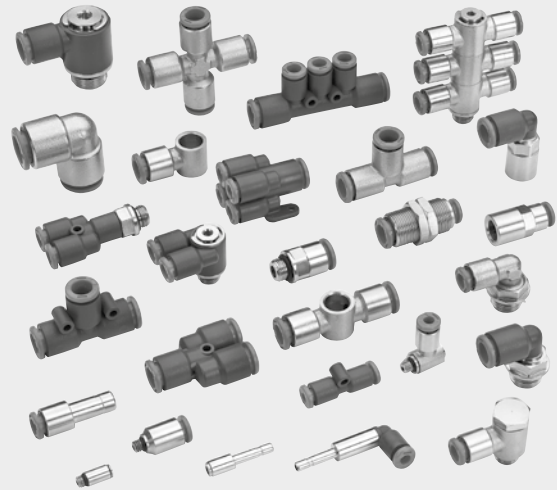

| TECHNICAL DATA | METRIC or G (BSP) * | UNF or NPT ** |
|----------------------------------------------|------------------------------------------------------------------|-------------------------------------------------------|
| Threaded coupling | Metric: M3 - M5 - M7 - M12x1.5 G (BSP): 1/8 - 1/4 - 3/8 - 1/2 | UNF: 10-32 NPT: 1/8 - 1/4 - 3/8 - 1/2 |
| Diameter of the pipe | 3 - 3.17 - 4 - 5 - 6 - 8 - 10 - 12 - 14 | 1/8 - 5/32 - 1/4 - 5/16 - 3/8 - 1/2 |
| Temperature range for brass fittings | °C | - 20 to + 80 |
| | °F | - 4 to 176 |
| Temperature range for technopolymer fittings | °C | - 20 to + 60 |
| | °F | - 4 to 140 |
| Pressure range for brass fittings | | - 0.99 bar to 16 bar / - 0.099 MPa to 1.6 MPa |
| Pressure range for technopolymer fittings | | - 0.99 bar to 12 bar / - 0.099 MPa to 1.2 MPa |
| Recommended pipe | | Rilsan PA 11 - Nylon 6 - Polyamide 12 - Polypropylene |
| Fluid | | Vacuum - Compressed air |

* Metric cylindrical threads according to ISO 262

Cylindrical threads according to ISO 228-1, identified with a letter G. They also correspond to BSP or more precisely to BSPP designation (P stands for Parallel).

Conical threads according to ISO 7-1, identified by a letter R. They also correspond to BSP or more precisely to BSPT designation (T stands for Tapered).

** UNF cylindrical threads, according to ANSI B 1.1

NPT conical threads. Female threads are in accordance with ANSI B 1-20, male threads are a Metal Work specifically designed solution that is compatible with ANSI B 1-20 threads (see page D1.8)

COMPONENTS

- ① Ring or release bushing: technopolymer
- ② Locking bushing: brass or technopolymer
- ③ Body: brass or technopolymer
- ④ Clamping spring: stainless steel (for pipes Ø 3 and Ø 3.17: brass gripper)
- ⑤ Spring supporting ring: technopolymer
- ⑥ Seal: NBR

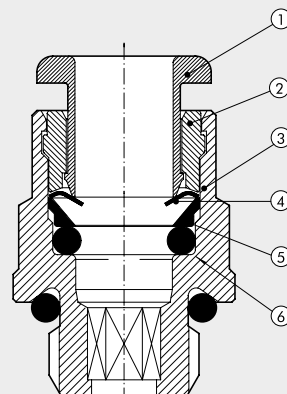

O-RING BELOW R FITTINGS

| Thread | Initials | Dimensions of O-ring |
|----------------------------------------------|----------|----------------------|
| M3 | - | 2.6 x 1 |
| M5 (for $\varnothing 3 - \varnothing 3.17$) | - | 3 x 1.2 |
| M5 - 10-32 UNF | - | 3.5 x 1.2 |
| M7 | - | 5 x 1.5 |
| M12x1.5 | - | 9.75 x 1.78 |
| G 1/8 - 1/8 NPT | 2031 | 7.66 x 1.78 |
| G 1/4 - 1/4 NPT | 2043 | 10.82 x 1.78 |
| G 3/8 - 3/8 NPT | 2056 | 14 x 1.78 |
| G 1/2 - 1/2 NPT | 3068 | 17.13 x 2.62 |

SCREWING TORQUE

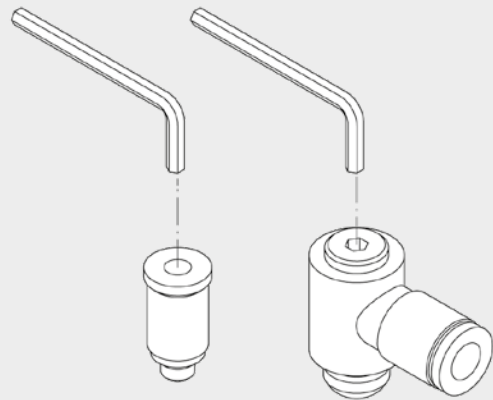
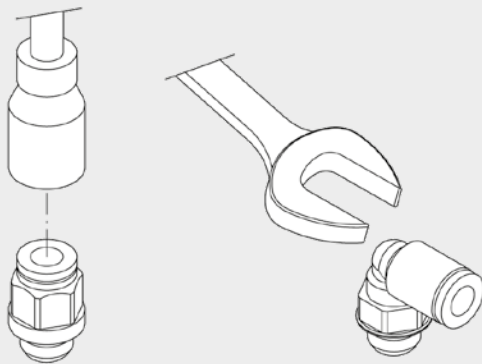

| Thread | Max. Torque [Nm] |
|-----------------|------------------|
| M3 | 0.4 |
| M5 - 10-32 UNF | 1.8 |
| M7 | 2.5 |
| M12x1.5 | 8 |
| G 1/8 - 1/8 NPT | 6 |
| G 1/4 - 1/4 NPT | 8 |
| G 3/8 - 3/8 NPT | 10 |
| G 1/2 - 1/2 NPT | 15 |

| CH [mm] | CH [inc] | Max. Torque [Nm] |
|---------|------------|-----------------------------------|
| 1.5 | - | 0.4 |
| 2 | 5/64 | 0.7 |
| 2.5 | - | 1.2 |
| 3 | 0.118 | 2.5 |
| 4 | 0.157 | 5 |
| 5 | 0.197 | 8 |
| Over 5 | Over 0.197 | See the values concerning threads |

N.B.: When using a socket spanner, the torque must not exceed that of the thread (e.g. fitting RL1 6 M7, with a 4 mm thread, has a maximum torque of 2.5 Nm, highest value of the thread)

GENERAL FEATURES

All fittings have cylindrical threading and incorporate a O-ring. The use of an O-ring considerably improves the seal of angled, rough, and slightly convex surfaces. (PTFE) is no longer used.

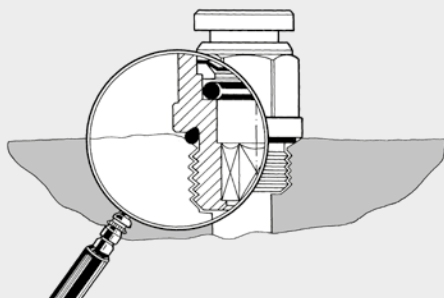

IDENTIFICATION OF FITTINGS FOR INCH PIPES AND UNF or NPT THREAD

The push-in fittings for inch pipes or with NPT thread have an identification mark (see below).

N.B.: threadless fittings for 1/8, 5/32 and 5/16 pipes do not bear an identification mark as they are used in Europe.

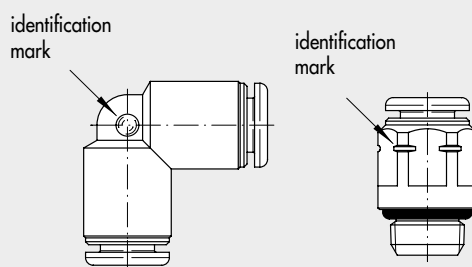

FITTINGS WITH ALLEN WRENCH - ADVANTEGES

An Allen wrench is used to assemble rotary fittings even with very close centre distances.

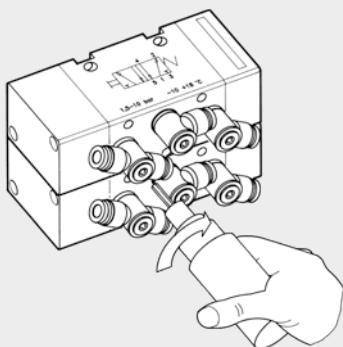

The special configuration with two O-rings allows maximum orientation so as to follow pipe movement in the specific application.

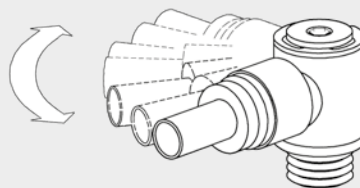

Fittings with a built-in gasket and reduced height (H) with the same threaded coupling and pipe diameter.

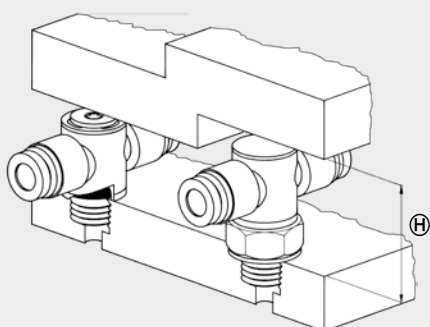

IDEA: TO USE 4 PUSH-IN FITTINGS ONLY

- With four type of push-in fittings that are R1, R4, R5, R6 it is possible to do every type of connection for a pneumatic circuit.
- Sharp drop in the number of fittings to be stocked and hence reduced operating costs.

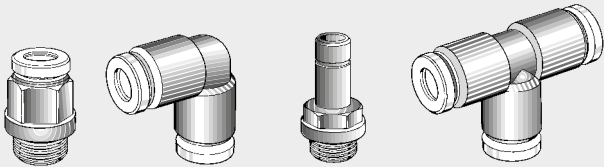

A single tee can give central tees and lateral tees.

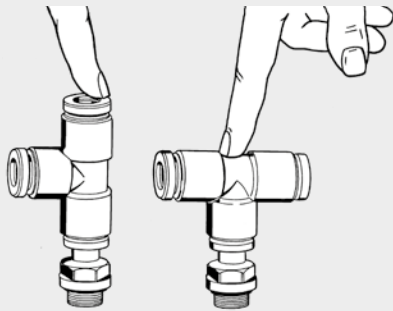

Pre-assembling fittings on the workbench with pneumatic tool even with very close centre distances.

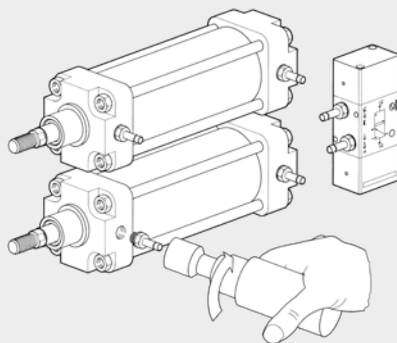

Quick connection and completion of the pneumatic circuit.

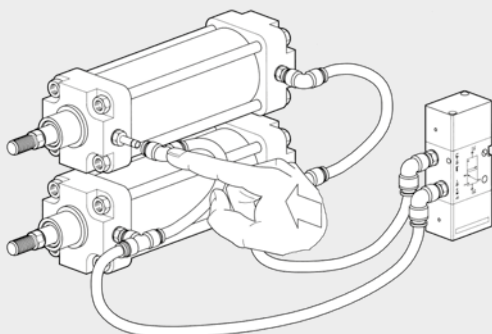

Mounting fittings with an Allen wrench or pneumatic tool. All the elbows and tees are rotary. Drastic reduction in assembly times.

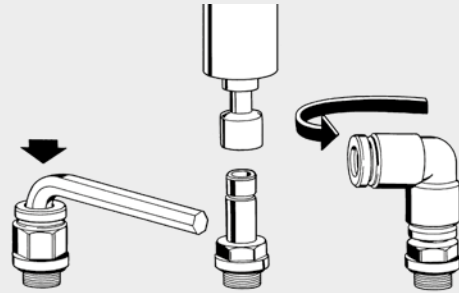

The pipe is easy to assemble by pressing lightly on the pusher ring. To remove the fitting, merely push radially on the key.

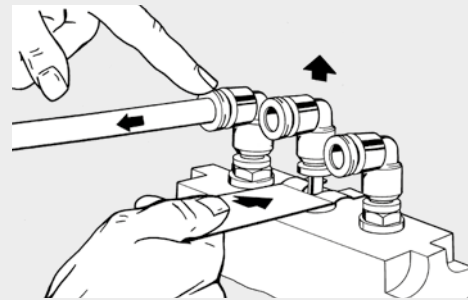

Pre-assembling fittings and pipe sections on the workbench. Pre-assembled configurations can be stocked for assembly in series.

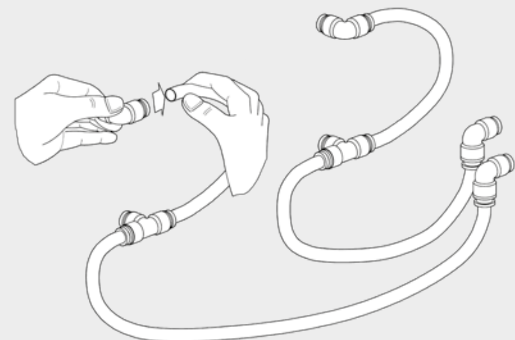

THE METAL WORK SOLUTION WITH CAPTIVATED O-RING FOR THREAD NPT

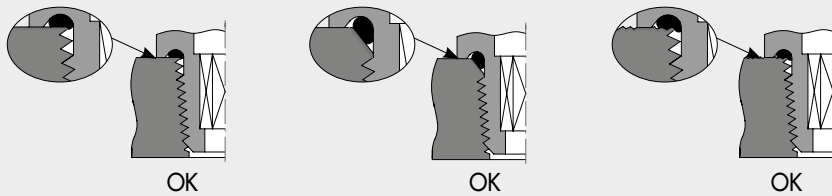

- Perfect seal even on flat, conical and raw surfaces.

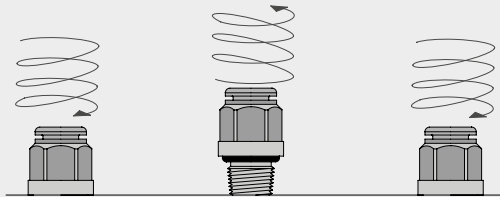

- Can be re-used thousands of times.

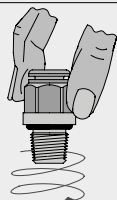

- The pneumatic seal is obtained by simply screwing the fitting in by hand. Tighten firmly without forcing to prevent unscrewing.

METAL WORK

CONVENTIONAL FITTINGS

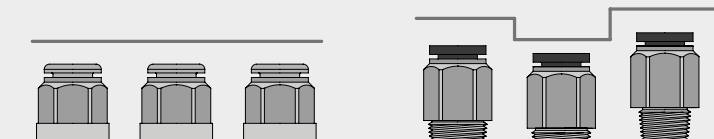

- Constant height of the mounted fitting regardless of the tolerance of the thread, or to the torque.

METAL WORK

CONVENTIONAL FITTINGS

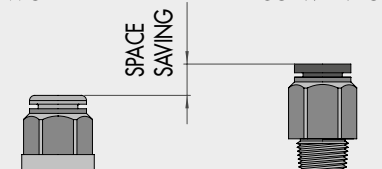

- Reduced fitting height.

THE SOLUTION OFFERS NUMEROUS ADVANTAGES OVER CONVENTIONAL SOLUTIONS

Solution with NPTF Dry seal thread

- It operates correctly if the male and female thread are made exactly to standard, otherwise there will be air leaks.

Solution with thread coated with teflon® or other sealant

- A limited number of assemblies is possible after which there will be no seal.
- Particles of sealant detach from the fitting or enter the compressed air system, which affects cleanness of the compressed air.

Solution with teflon® or rubber ring on the thread

- Guaranteed seal with just a few turns.

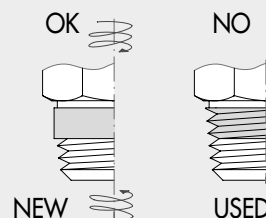
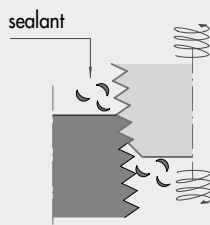
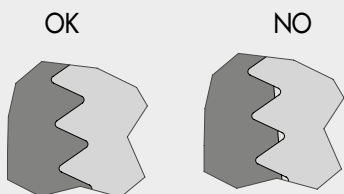



BRASS PUSH-IN FITTINGS FOR mm TUBES AND G (BSP) or METRIC THREAD

STRAIGHT, CYLINDRICAL, MALE (R1)

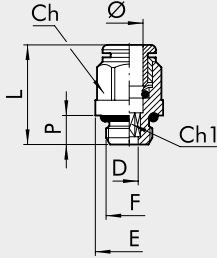

| Code | Ref. | Ø | F | Ch | Ch1 | P | L | D | E |
|---------|------|------|---------|-------|-----|-----|------|------|------|
| 2001B01 | R1 | 3 | M3 | Ø 5.8 | 1.5 | 3 | 12.6 | 1.5 | 5.8 |
| 2001B02 | R1 | 3 | M5 | Ø 5.8 | 2 | 3.5 | 13 | 2 | 5.8 |
| 2001A01 | R1 | 3.17 | M3 | Ø 5.8 | 1.5 | 3 | 12.6 | 1.5 | 5.8 |
| 2001A02 | R1 | 3.17 | M5 | Ø 5.8 | 2 | 3.5 | 13 | 2 | 5.8 |
| 2L01001 | RL1 | 4 | M5 | Ø 9 | 2.5 | 4 | 20.3 | 2.6 | 9 |
| 2L01020 | RL1 | 4 | M7 | Ø 9 | 3 | 5 | 18.9 | 3.1 | 9.8 |
| 2L01002 | RL1 | 4 | 1/8 | 10 | 3 | 6 | 18 | 3.1 | 14 |
| 2L01003 | RL1 | 4 | 1/4 | 10 | 3 | 8 | 19.8 | 3.1 | 18 |
| 2001004 | R1 | 5 | M5 | Ø 12 | 2.5 | 4 | 22.5 | 2.6 | 12 |
| 2001005 | R1 | 5 | 1/8 | 13 | 3 | 6 | 22 | 3.1 | 15 |
| 2001006 | R1 | 5 | 1/4 | 12 | 3 | 8 | 24 | 3.1 | 18 |
| 2L01000 | RL1 | 6 | M5 | Ø 11 | 2.5 | 4 | 21.9 | 2.6 | 11 |
| 2L01021 | RL1 | 6 | M7 | Ø 11 | 4 | 5 | 23 | 4.1 | 11 |
| 2L01101 | RL1 | 6 | M12x1.5 | 12 | 4 | 8 | 23.2 | 4.1 | 17 |
| 2L01007 | RL1 | 6 | 1/8 | 12 | 4 | 6 | 21.6 | 4.1 | 14 |
| 2L01008 | RL1 | 6 | 1/4 | 12 | 4 | 8 | 20.3 | 4.1 | 18 |
| 2L01102 | RL1 | 8 | M12x1.5 | 14 | 6 | 8 | 24.5 | 6.2 | 17 |
| 2L01009 | RL1 | 8 | 1/8 | 13 | 5 | 6 | 25.4 | 5.2 | 14 |
| 2L01010 | RL1 | 8 | 1/4 | 14 | 6 | 8 | 24.4 | 6.2 | 18 |
| 2L01011 | RL1 | 8 | 3/8 | 14 | 6 | 9 | 22.8 | 6.2 | 22 |
| 2L01012 | RL1 | 10 | 1/4 | 16 | 7 | 8 | 29.2 | 7.2 | 18 |
| 2L01013 | RL1 | 10 | 3/8 | 16 | 8 | 9 | 26.5 | 8.2 | 22 |
| 2L01018 | RL1 | 10 | 1/2 | 16 | 8 | 11 | 29.8 | 8.2 | 26 |
| 2001019 | RL1 | 12 | 1/4 | 19 | 7 | 8 | 30.5 | 7.2 | 21 |
| 2001014 | RL1 | 12 | 3/8 | 19 | 10 | 9 | 28.1 | 10.2 | 22 |
| 2001015 | RL1 | 12 | 1/2 | 19 | 10 | 11 | 29.3 | 10.2 | 26 |
| 2001016 | RL1 | 14 | 3/8 | 22 | 10 | 9 | 33.8 | 10.2 | 24.6 |
| 2001017 | RL1 | 14 | 1/2 | 22 | 12 | 11 | 31.5 | 12.2 | 26 |

STRAIGHT, CONICAL, MALE (R1C)

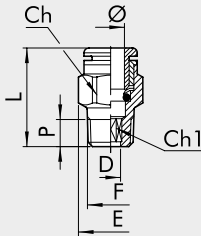

| Code | Ref. | Ø | F | Ch | Ch1 | D | E | L | P |
|---------|------|----|-----------------|----|-----|------|------|------|-----|
| 2L01C02 | RL1C | 4 | 1/8 | 10 | 3 | 3.1 | 11.3 | 18.5 | 6.2 |
| 2L01C07 | RL1C | 6 | 1/8 | 12 | 4 | 4.1 | 13.5 | 22.5 | 6.2 |
| 2L01C08 | RL1C | 6 | 1/4 | 12 | 4 | 4.1 | 13.2 | 22.3 | 8.5 |
| 2001Z07 | RL1Z | 6 | 12x1 conical | 12 | 4 | 4.1 | 13.2 | 23.5 | 9 |
| 2001Z08 | RL1Z | 6 | 12x1.25 conical | 12 | 4 | 4.1 | 13.2 | 23.5 | 9 |
| 2L01C09 | RL1C | 8 | 1/8 | 13 | 6 | 6.2 | 14.3 | 26 | 6.2 |
| 2L01C10 | RL1C | 8 | 1/4 | 14 | 6 | 6.2 | 15.8 | 25.5 | 8.5 |
| 2L01C11 | RL1C | 8 | 3/8 | 14 | 6 | 6.2 | 16.6 | 24.9 | 9 |
| 2L01C13 | RL1C | 10 | 1/4 | 16 | 7 | 7.2 | 17.7 | 28.9 | 8.5 |
| 2L01C14 | RL1C | 10 | 3/8 | 16 | 8 | 8.2 | 17.7 | 26 | 9 |
| 2001C15 | RL1C | 12 | 3/8 | 19 | 10 | 10.2 | 21 | 28.5 | 9 |
| 2001C16 | RL1C | 12 | 1/2 | 19 | 10 | 10.2 | 21.3 | 26.6 | 11 |

STRAIGHT, FEMALE (R2)

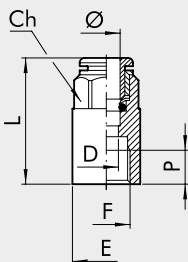

| Code | Ref. | Ø | F | Ch | P | L | D | E |
|---------|------|------|-----|----|-----|------|-----|------|
| 2002B02 | R2 | 3 | M5 | 7 | 4.5 | 15.7 | 2.5 | 7.8 |
| 2002A02 | R2 | 3.17 | M5 | 7 | 4.5 | 15.7 | 2.5 | 7.8 |
| 2L02001 | RL2 | 4 | 1/8 | 10 | 7 | 26.2 | 3 | 14 |
| 2L02002 | RL2 | 4 | 1/4 | 10 | 8 | 28.6 | 3 | 17 |
| 2002003 | R2 | 5 | 1/8 | 12 | 7 | 27 | 4 | 14 |
| 2002004 | R2 | 5 | 1/4 | 12 | 8 | 29.5 | 4 | 17 |
| 2L02005 | RL2 | 6 | 1/8 | 12 | 7 | 27.1 | 5 | 14 |
| 2L02006 | RL2 | 6 | 1/4 | 12 | 8 | 29.3 | 5 | 17 |
| 2L02007 | RL2 | 8 | 1/8 | 13 | 7 | 28.1 | 7 | 14 |
| 2L02008 | RL2 | 8 | 1/4 | 14 | 8 | 30 | 7 | 17 |
| 2L02009 | RL2 | 10 | 1/4 | 16 | 8 | 31.8 | 8 | 17.7 |
| 2L02010 | RL2 | 10 | 3/8 | 16 | 10 | 36.8 | 8 | 20.8 |
| 2L02011 | RL2 | 12 | 3/8 | 19 | 10 | 37 | 10 | 20.8 |
| 2L02012 | RL2 | 12 | 1/2 | 19 | 11 | 40.5 | 10 | 23.8 |

BRASS PUSH-IN FITTINGS FOR mm TUBES AND G (BSP) or METRIC THREAD

FITTINGS

G
BSP

STRAIGHT, INTERMEDIATE (R3)

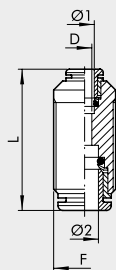

| Code | Ref. | Ø 1 | Ø 2 | F | L | D |
|---------|------|------|------|---------|------|-----|
| 2003A02 | R3 | 3 | 3 | M8x0.75 | 18.4 | 2 |
| 2003A01 | R3 | 3.17 | 3.17 | M8x0.75 | 18.4 | 2 |
| 2103001 | RL3 | 4 | 4 | M11x1 | 30.6 | 2.5 |
| 2003002 | R3 | 5 | 5 | M14x1 | 33.5 | 4 |
| 2103003 | RL3 | 6 | 6 | M13x1 | 33 | 4.5 |
| 2103004 | RL3 | 8 | 8 | M15x1 | 35.7 | 6.5 |
| 2103005 | RL3 | 10 | 10 | M17x1 | 39.2 | 8 |
| 2003006 | RL3 | 12 | 12 | M20x1 | 40.7 | 10 |
| 2003007 | RL3 | 14 | 14 | M24x1 | 45.9 | 12 |
| 2103301 | RL3 | 4 | 6 | M13x1 | 32.7 | 2.5 |
| 2103302 | RL3 | 4 | 8 | M15x1 | 34.4 | 2.5 |
| 2103303 | RL3 | 6 | 8 | M15x1 | 35 | 4.5 |
| 2103304 | RL3 | 6 | 10 | M17x1 | 37.5 | 4.5 |
| 2103306 | RL3 | 6 | 12 | M20x1 | 39 | 4.5 |
| 2103305 | RL3 | 8 | 10 | M17x1 | 37.8 | 6.5 |
| 2103307 | RL3 | 8 | 12 | M20x1 | 40.1 | 6 |
| 2103308 | RL3 | 10 | 12 | M20x1 | 40.8 | 8 |

ELBOW, INTERMEDIATE (R4)

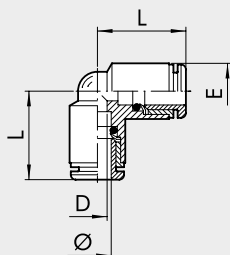

| Code | Ref. | Ø | L | D | E |
|---------|------|------|------|-----|------|
| 2004A02 | R4 | 3 | 10.4 | 2 | 6.3 |
| 2004A01 | R4 | 3.17 | 10.4 | 2 | 6.3 |
| 2104001 | RL4 | 4 | 16.7 | 2.5 | 9.5 |
| 2004002 | R4 | 5 | 19.2 | 3 | 13.5 |
| 2104003 | RL4 | 6 | 19 | 4.5 | 11.5 |
| 2104004 | RL4 | 8 | 21.3 | 6.5 | 13.5 |
| 2104005 | RL4 | 10 | 23.3 | 8 | 16 |
| 2004006 | RL4 | 12 | 26 | 10 | 20.5 |
| 2004007 | RL4 | 14 | 29.3 | 12 | 22 |

TEE, INTERMEDIATE (R5)

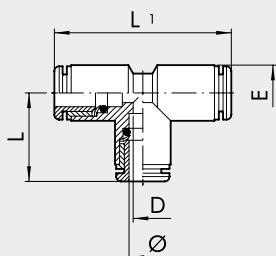

| Code | Ref. | Ø | L | L1 | D | E |
|---------|------|------|------|------|-----|------|
| 2005A02 | R5 | 3 | 10.4 | 20.8 | 2 | 6.3 |
| 2005A01 | R5 | 3.17 | 10.4 | 20.8 | 2 | 6.3 |
| 2105001 | RL5 | 4 | 16.7 | 33.4 | 2.5 | 9.5 |
| 2005002 | R5 | 5 | 19.2 | 38.4 | 3 | 13.5 |
| 2105003 | RL5 | 6 | 19 | 38 | 4.5 | 11.5 |
| 2105004 | RL5 | 8 | 21.3 | 42.6 | 6.5 | 13.5 |
| 2105005 | RL5 | 10 | 23.3 | 46.6 | 8 | 16 |
| 2005006 | RL5 | 12 | 26 | 52 | 10 | 20.5 |
| 2005007 | RL5 | 14 | 29.3 | 58.6 | 12 | 22 |



THREADED ADAPTER (R6)

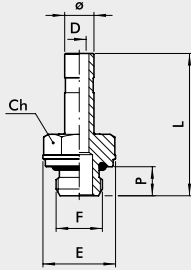

| Code | Ref. | Ø | F | Ch | P | L | D | E |
|---------|------|------|---------|----|-----|------|-----|-----|
| 2006A02 | R6 | 3 | M5 | 5 | 3.5 | 17.1 | 2 | 5.8 |
| 2006A01 | R6 | 3.17 | M5 | 5 | 3.5 | 17.1 | 2 | 5.8 |
| 2006001 | R6 | 4 | M5 | 8 | 4 | 25.2 | 2.5 | 9 |
| 2006020 | R6 | 4 | M7 | 8 | 5 | 26.5 | 2.5 | 9.8 |
| 2006002 | R6 | 4 | 1/8 | 13 | 6 | 28.9 | 2.5 | 15 |
| 2006003 | R6 | 4 | 1/4 | 14 | 8 | 32.4 | 2.2 | 18 |
| 2006004 | R6 | 5 | M5 | 8 | 4 | 25.2 | 2.7 | 9 |
| 2006005 | R6 | 5 | 1/8 | 13 | 6 | 28.9 | 3 | 15 |
| 2006006 | R6 | 5 | 1/4 | 14 | 8 | 32.4 | 3 | 18 |
| 2006000 | R6 | 6 | M5 | 9 | 4 | 25.7 | 2.7 | 10 |
| 2006021 | R6 | 6 | M7 | 8 | 5 | 27 | 4 | 9.8 |
| 2006007 | R6 | 6 | 1/8 | 13 | 6 | 29.4 | 4 | 15 |
| 2006008 | R6 | 6 | 1/4 | 14 | 8 | 32.9 | 4 | 18 |
| 2006009 | R6 | 8 | 1/8 | 13 | 6 | 30.6 | 5.5 | 15 |
| 2006010 | R6 | 8 | 1/4 | 14 | 8 | 34 | 6 | 18 |
| 2006011 | R6 | 8 | 3/8 | 17 | 9 | 35.4 | 6 | 22 |
| 2006012 | R6 | 10 | 1/4 | 14 | 8 | 38.2 | 7.8 | 18 |
| 2006013 | R6 | 10 | 3/8 | 17 | 9 | 38.7 | 8 | 22 |
| 2006022 | R6 | 10 | 1/2 | 19 | 11 | 41 | 8 | 26 |
| 2006019 | R6 | 12 | 1/4 | 14 | 8 | 40.7 | 7.8 | 18 |
| 2006014 | R6 | 12 | 3/8 | 17 | 9 | 42.2 | 10 | 22 |
| 2006015 | R6 | 12 | 1/2 | 22 | 11 | 44.2 | 10 | 26 |
| 2006016 | R6 | 14 | 3/8 | 17 | 9 | 46.2 | 10 | 22 |
| 2006017 | R6 | 14 | 1/2 | 22 | 11 | 48.2 | 12 | 26 |
| 2006101 | R6 | 6 | M12x1.5 | 13 | 8 | 33 | 4 | 17 |
| 2006102 | R6 | 8 | M12x1.5 | 13 | 8 | 33.7 | 6 | 17 |

EXTENDED THREADED ADAPTER (R18)

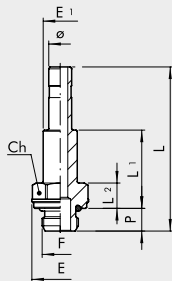

| Code | Ref. | Ø | F | Ch | P | L | L1 | L2 | E | E1 |
|---------|------|----|-----|----|---|------|------|-----|----|----|
| 2018002 | R18 | 4 | 1/8 | 13 | 6 | 40.4 | 18.2 | 6.7 | 15 | 7 |
| 2018007 | R18 | 6 | 1/8 | 13 | 6 | 43.4 | 20.7 | 6.7 | 15 | 9 |
| 2018008 | R18 | 6 | 1/4 | 14 | 8 | 46.9 | 22.2 | 8.2 | 18 | 9 |
| 2018009 | R18 | 8 | 1/8 | 13 | 6 | 46.5 | 22.7 | 6.7 | 15 | 11 |
| 2018010 | R18 | 8 | 1/4 | 14 | 8 | 50 | 24.2 | 8.2 | 18 | 11 |
| 2018011 | R18 | 8 | 3/8 | 17 | 9 | 51.4 | 24.7 | 8.7 | 22 | 13 |
| 2018012 | R18 | 10 | 1/4 | 14 | 8 | 57.2 | 27.2 | 8.2 | 18 | 12 |
| 2018013 | R18 | 10 | 3/8 | 17 | 9 | 58.7 | 27.7 | 8.7 | 22 | 12 |

EXTENSION (R7)

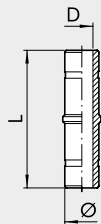

| Code | Ref. | Ø | L | D |
|---------|------|----|------|----|
| 2007001 | R7 | 4 | 34 | 2 |
| 2007002 | R7 | 5 | 34 | 3 |
| 2007003 | R7 | 6 | 37.5 | 4 |
| 2007004 | RL7 | 8 | 37.5 | 6 |
| 2007005 | R7 | 10 | 45 | 8 |
| 2007006 | R7 | 12 | 48 | 10 |
| 2007007 | R7 | 14 | 58 | 12 |

BRASS PUSH-IN FITTINGS FOR mm TUBES AND G (BSP) or METRIC THREAD

FITTINGS



REDUCER (R8)

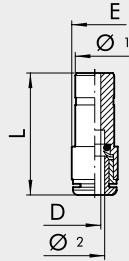

| Code | Ref. | Ø 1 | Ø 2 | L | D | E |
|---------|------|-----|------|------|-----|------|
| 2008A01 | R8 | 4 | 3 | 26 | 2 | 6.3 |
| 2008A02 | R8 | 4 | 3.17 | 26 | 2 | 6.3 |
| 2008001 | RL8 | 5 | 4 | 32.2 | 3 | 9.5 |
| 2108002 | RL8 | 6 | 4 | 29.9 | 2.8 | 9.5 |
| 2008003 | R8 | 6 | 5 | 36 | 4 | 12 |
| 2108004 | RL8 | 8 | 4 | 28.7 | 2.8 | 9.5 |
| 2008005 | R8 | 8 | 5 | 34.5 | 4 | 12 |
| 2108006 | RL8 | 8 | 6 | 31.9 | 4.5 | 11.5 |
| 2108007 | RL8 | 10 | 6 | 36.2 | 5 | 11.5 |
| 2108008 | RL8 | 10 | 8 | 40.8 | 7 | 14 |
| 2008009 | RL8 | 12 | 4 | 36.7 | 3 | 13 |
| 2008010 | RL8 | 12 | 6 | 38.5 | 5 | 13 |
| 2008011 | RL8 | 12 | 8 | 40.1 | 7 | 14 |
| 2008015 | RL8 | 12 | 10 | 44.3 | 8.2 | 16 |
| 2008014 | RL8 | 14 | 8 | 44.1 | 7 | 15.5 |
| 2008017 | RL8 | 14 | 10 | 44.3 | 8.2 | 16 |
| 2008018 | RL8 | 14 | 12 | 50 | 10 | 19.5 |

ADDITION

| | | | | | | |
|---------|-------|---|---|------|-----|------|
| 2009001 | RL8/M | 4 | 6 | 34.5 | 2.5 | 11.5 |
|---------|-------|---|---|------|-----|------|

PLUG (R9)

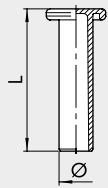

| Code | Ref. | Ø | L | MATERIAL |
|---------|------|------|------|---------------|
| 2010A02 | R9 | 3 | 20 | Brass |
| 2110A01 | RL9T | 3.17 | 19.6 | Technopolymer |
| 2110001 | RL9T | 4 | 27 | Technopolymer |
| 2010002 | R9 | 5 | 27 | Brass |
| 2110003 | RL9T | 6 | 29.8 | Technopolymer |
| 2110004 | RL9T | 8 | 33.6 | Technopolymer |
| 2110005 | RL9T | 10 | 36.8 | Technopolymer |
| 2110006 | RL9T | 12 | 39 | Technopolymer |
| 2010007 | R9 | 14 | 39.5 | Brass |

STRAIGHT, INTERMEDIATE, BULKMTAD (R10)

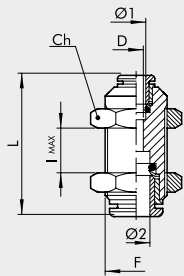

| Code | Ref. | Ø 1 | Ø 2 | F | Ch | L | D | I max |
|---------|------|------|------|---------|----|------|-----|-------|
| 2011A02 | R10 | 3 | 3 | M8x0.75 | 10 | 18.4 | 2 | 5 |
| 2011A01 | R10 | 3.17 | 3.17 | M8x0.75 | 10 | 18.4 | 2 | 5 |
| 2111001 | RL10 | 4 | 4 | M11x1 | 13 | 30.6 | 2.5 | 11 |
| 2011002 | R10 | 5 | 5 | M14x1 | 17 | 33.5 | 4 | 8 |
| 2111003 | RL10 | 6 | 6 | M13x1 | 16 | 33 | 4.5 | 12 |
| 2111004 | RL10 | 8 | 8 | M15x1 | 17 | 35.7 | 6.5 | 13.5 |
| 2111005 | RL10 | 10 | 10 | M17x1 | 20 | 39.2 | 8 | 17 |
| 2011006 | RL10 | 12 | 12 | M20x1 | 24 | 40.7 | 10 | 20.3 |
| 2011007 | RL10 | 14 | 14 | M24x1 | 27 | 45.9 | 12 | 21.9 |
| 2111301 | RL10 | 4 | 6 | M13x1 | 16 | 32.7 | 2.5 | 11 |
| 2111302 | RL10 | 4 | 8 | M15x1 | 17 | 34.4 | 2.5 | 12 |
| 2111303 | RL10 | 6 | 8 | M15x1 | 17 | 35 | 4.5 | 13 |
| 2111304 | RL10 | 6 | 10 | M17x1 | 20 | 37.5 | 4.5 | 14.5 |
| 2111306 | RL10 | 6 | 12 | M20x1 | 24 | 39 | 4.5 | 16 |
| 2111305 | RL10 | 8 | 10 | M17x1 | 20 | 37.8 | 6.5 | 15 |
| 2111307 | RL10 | 8 | 12 | M20x1 | 24 | 40.1 | 6 | 17.5 |
| 2111308 | RL10 | 10 | 12 | M20x1 | 24 | 40.8 | 8 | 19 |



SINGLE RING (R13)

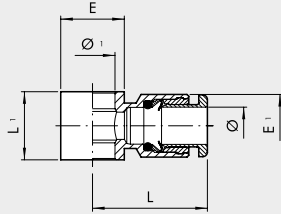

| Code | Ref. | Ø | Ø 1 | L | L1 | E | E1 |
|---------|------|------|-----|------|----|-----|------|
| 2012A02 | R13 | 3 | M5 | 12.9 | 9 | 9 | 7 |
| 2012A01 | R13 | 3.17 | M5 | 12.9 | 9 | 9 | 7 |
| 2012001 | RL13 | 4 | M5 | 20.2 | 9 | 9.5 | 9.5 |
| 2012002 | RL13 | 4 | 1/8 | 21.3 | 15 | 14 | 9.5 |
| 2012003 | R13 | 5 | M5 | 23.8 | 9 | 9.5 | 12 |
| 2012004 | R13 | 5 | 1/8 | 24.8 | 15 | 14 | 12 |
| 2012005 | RL13 | 6 | 1/8 | 23 | 15 | 14 | 11.5 |
| 2012006 | RL13 | 6 | 1/4 | 24.5 | 17 | 18 | 11.5 |
| 2012007 | RL13 | 8 | 1/8 | 24.8 | 15 | 14 | 13.8 |
| 2012008 | RL13 | 8 | 1/4 | 26.5 | 17 | 18 | 13.8 |
| 2012009 | RL13 | 8 | 3/8 | 28.5 | 20 | 21 | 13.8 |
| 2012010 | RL13 | 10 | 1/4 | 31.4 | 17 | 18 | 16.5 |
| 2012011 | RL13 | 10 | 3/8 | 32.8 | 20 | 21 | 16 |
| 2012013 | RL13 | 12 | 1/4 | 33 | 17 | 18 | 19.5 |
| 2012012 | RL13 | 12 | 3/8 | 35.3 | 20 | 21 | 19.5 |
| 2012014 | RL13 | 12 | 1/2 | 37 | 24 | 26 | 19.5 |
| 2012017 | RL13 | 14 | 1/2 | 35 | 24 | 26 | 22 |

For the rods series D, see page D2.15

DUAL RING (R14)

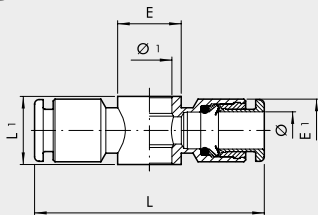

| Code | Ref. | Ø | Ø 1 | L | L1 | E | E1 |
|---------|------|----|-----|------|----|-----|------|
| 2013001 | RL14 | 4 | M5 | 40.4 | 9 | 9.5 | 9.5 |
| 2013002 | RL14 | 4 | 1/8 | 42.6 | 15 | 14 | 9.5 |
| 2013003 | R14 | 5 | M5 | 48 | 9 | 9.5 | 12 |
| 2013004 | R14 | 5 | 1/8 | 49.5 | 15 | 14 | 13.5 |
| 2013005 | RL14 | 6 | 1/8 | 46 | 15 | 14 | 11.5 |
| 2013006 | RL14 | 6 | 1/4 | 49 | 17 | 18 | 11.5 |
| 2013007 | RL14 | 8 | 1/8 | 49.6 | 15 | 14 | 13.8 |
| 2013008 | RL14 | 8 | 1/4 | 53 | 17 | 18 | 13.8 |
| 2013009 | RL14 | 8 | 3/8 | 57 | 20 | 21 | 13.8 |
| 2013010 | RL14 | 10 | 1/4 | 62.8 | 17 | 18 | 16.5 |
| 2013011 | RL14 | 10 | 3/8 | 65.6 | 20 | 21 | 16 |

For the rods series D, see page D2.15

ROD, MALE SINGLE ROTARY RING (R15)

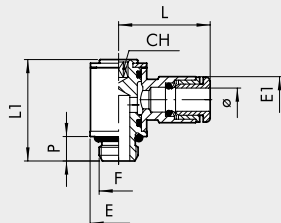

| Code | Ref. | Ø | F | CH | P | L | L1 | E | E1 |
|---------|------|------|-----|-----|-----|------|------|-----|------|
| 2014101 | R15 | 3 | M3 | 1.5 | 3 | 12.2 | 13.2 | 5.8 | 5.8 |
| 2014102 | R15 | 3.17 | M3 | 1.5 | 3 | 12.2 | 13.2 | 5.8 | 5.8 |
| 2014103 | R15 | 3 | M5 | 2 | 3.5 | 12.7 | 13.7 | 5.8 | 7 |
| 2014104 | R15 | 3.17 | M5 | 2 | 3.5 | 12.7 | 13.7 | 5.8 | 7 |
| 2L14001 | RL15 | 4 | M5 | 2 | 4 | 20.2 | 18.4 | 9.5 | 9.5 |
| 2L14020 | RL15 | 4 | M7 | 3 | 5 | 20.2 | 18.5 | 9.8 | 9.5 |
| 2L14002 | RL15 | 4 | 1/8 | 3 | 6 | 21.3 | 24.9 | 14 | 9.5 |
| 2014003 | R15 | 5 | M5 | 2 | 4 | 24 | 19 | 9.9 | 12 |
| 2014004 | R15 | 5 | 1/8 | 3 | 6 | 25 | 27 | 14 | 12 |
| 2L14106 | RL15 | 6 | M5 | 2 | 4 | 23.5 | 18.4 | 9.5 | 11.3 |
| 2L14021 | RL15 | 6 | M7 | 3 | 5 | 23.5 | 18.5 | 9.8 | 11.3 |
| 2L14005 | RL15 | 6 | 1/8 | 3 | 6 | 23 | 24.9 | 14 | 11.5 |
| 2L14007 | RL15 | 6 | 1/4 | 4 | 8 | 24.5 | 29.4 | 18 | 11.5 |
| 2L14006 | RL15 | 8 | 1/8 | 3 | 6 | 24.8 | 24.9 | 14 | 13.8 |
| 2L14008 | RL15 | 8 | 1/4 | 4 | 8 | 26.5 | 29.4 | 18 | 13.8 |
| 2L14013 | RL15 | 8 | 3/8 | 5 | 9 | 28.5 | 35.6 | 22 | 13.8 |
| 2L14009 | RL15 | 10 | 1/4 | 4 | 8 | 31.4 | 29.4 | 18 | 16.5 |
| 2L14014 | RL15 | 10 | 3/8 | 5 | 9 | 32.8 | 35.6 | 22 | 16 |
| 2014010 | RL15 | 12 | 1/4 | 4 | 8 | 33 | 29.4 | 18 | 19.5 |
| 2014011 | RL15 | 12 | 3/8 | 5 | 9 | 35.3 | 35.6 | 22 | 19.5 |
| 2014012 | RL15 | 12 | 1/2 | 8 | 11 | 37 | 40.8 | 26 | 19.5 |
| 2014015 | RL15 | 14 | 1/2 | 8 | 11 | 35 | 40.8 | 26 | 22 |

G
BSP

ROD, MALE DUAL ROTARY RING (R16)

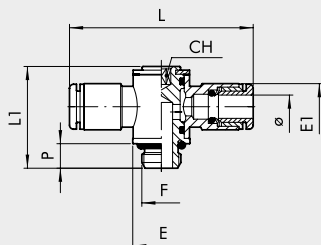

| Code | Ref. | Ø | F | CH | P | L | L1 | E | E1 |
|---------|------|----|-----|----|----|------|------|-----|------|
| 2L15001 | RL16 | 4 | M5 | 2 | 4 | 40.4 | 18.4 | 9.5 | 9.5 |
| 2L15020 | RL16 | 4 | M7 | 3 | 5 | 40.4 | 18.5 | 9.8 | 9.5 |
| 2L15002 | RL16 | 4 | 1/8 | 3 | 6 | 42.6 | 24.9 | 14 | 9.5 |
| 2015003 | R16 | 5 | M5 | 2 | 4 | 47.6 | 18.8 | 9.9 | 12 |
| 2015004 | R16 | 5 | 1/8 | 3 | 6 | 49.5 | 27 | 14 | 13.5 |
| 2L15106 | RL16 | 6 | M5 | 2 | 4 | 47 | 18.4 | 9.5 | 11.3 |
| 2L15021 | RL16 | 6 | M7 | 3 | 5 | 47 | 18.5 | 9.8 | 11.3 |
| 2L15005 | RL16 | 6 | 1/8 | 3 | 6 | 46 | 24.9 | 14 | 11.5 |
| 2L15007 | RL16 | 6 | 1/4 | 4 | 8 | 49 | 29.4 | 18 | 11.5 |
| 2L15006 | RL16 | 8 | 1/8 | 3 | 6 | 49.6 | 24.9 | 14 | 13.8 |
| 2L15008 | RL16 | 8 | 1/4 | 4 | 8 | 53 | 29.4 | 18 | 13.8 |
| 2L15013 | RL16 | 8 | 3/8 | 5 | 9 | 57 | 35.6 | 18 | 13.8 |
| 2L15009 | RL16 | 10 | 1/4 | 4 | 8 | 62.8 | 29.4 | 22 | 16.5 |
| 2L15014 | RL16 | 10 | 3/8 | 5 | 9 | 65.6 | 35.6 | 22 | 16 |
| 2015010 | RL16 | 12 | 1/4 | 4 | 8 | 66 | 29.4 | 18 | 19.5 |
| 2015011 | RL16 | 12 | 3/8 | 5 | 9 | 70.6 | 35.6 | 22 | 19.5 |
| 2015012 | RL16 | 12 | 1/2 | 8 | 11 | 74 | 40.8 | 26 | 19.5 |

ROTARY ELBOW, MALE, CYLINDRICAL (R31)

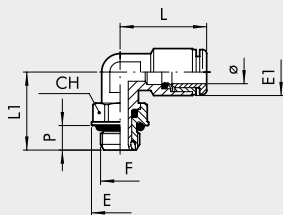

| Code | Ref. | Ø | F | CH | E | E1 | L | L1 | P |
|---------|------|----|-----|----|-----|------|------|------|----|
| 2L31001 | RL31 | 4 | M5 | 9 | 9.9 | 9.5 | 18.6 | 15.3 | 4 |
| 2L31002 | RL31 | 4 | 1/8 | 12 | 14 | 9.5 | 18.6 | 19.1 | 6 |
| 2L31003 | RL31 | 4 | 1/4 | 14 | 18 | 9.5 | 18.6 | 21.1 | 8 |
| 2031004 | R31 | 5 | M5 | 9 | 9.9 | 13.5 | 22.8 | 17.5 | 4 |
| 2031005 | R31 | 5 | 1/8 | 12 | 14 | 13.5 | 22.8 | 21 | 6 |
| 2031006 | R31 | 5 | 1/4 | 14 | 18 | 13.5 | 22.8 | 24.5 | 8 |
| 2L31007 | RL31 | 6 | M5 | 9 | 9.9 | 11.8 | 21.9 | 15.3 | 4 |
| 2L31008 | RL31 | 6 | 1/8 | 12 | 14 | 11.8 | 21.9 | 19.1 | 6 |
| 2L31009 | RL31 | 6 | 1/4 | 14 | 18 | 11.8 | 21.9 | 21.1 | 8 |
| 2L31010 | RL31 | 8 | 1/8 | 12 | 14 | 13.5 | 25.4 | 19.1 | 6 |
| 2L31011 | RL31 | 8 | 1/4 | 14 | 18 | 13.5 | 25.4 | 21.1 | 8 |
| 2L31012 | RL31 | 8 | 3/8 | 17 | 22 | 13.8 | 23.6 | 27.1 | 9 |
| 2L31013 | RL31 | 10 | 1/4 | 14 | 18 | 16 | 27.2 | 24.8 | 8 |
| 2L31014 | RL31 | 10 | 3/8 | 17 | 22 | 16 | 27.2 | 27.1 | 9 |
| 2031015 | RL31 | 10 | 1/2 | 22 | 26 | 16 | 27.2 | 30.7 | 11 |
| 2031016 | RL31 | 12 | 1/4 | 14 | 18 | 20 | 30 | 25.6 | 8 |
| 2031017 | RL31 | 12 | 3/8 | 17 | 22 | 20 | 30 | 27.1 | 9 |
| 2031018 | RL31 | 12 | 1/2 | 22 | 26 | 20 | 30 | 30.7 | 11 |
| 2031019 | RL31 | 14 | 1/2 | 22 | 26 | 21.3 | 33 | 32.3 | 11 |

ROTARY ELBOW, MALE, CONICAL (R31C)

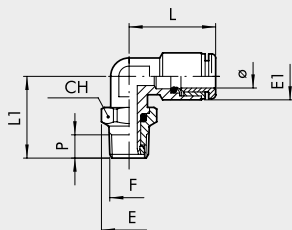

| Code | Ref. | Ø | F | CH | E | E1 | L | L1 | P |
|---------|--------|----|-----|----|------|------|------|------|-----|
| 2L31C02 | RL31/C | 4 | 1/8 | 12 | 13.3 | 9.5 | 18.6 | 19.8 | 6.2 |
| 2L31C03 | RL31/C | 4 | 1/4 | 14 | 15.4 | 9.5 | 18.6 | 22.6 | 8.5 |
| 2L31C08 | RL31/C | 6 | 1/8 | 12 | 13.3 | 11.8 | 21.9 | 19.8 | 6.2 |
| 2L31C09 | RL31/C | 6 | 1/4 | 14 | 15.4 | 11.8 | 21.9 | 22.6 | 8.5 |
| 2L31C10 | RL31/C | 8 | 1/8 | 12 | 13.3 | 13.5 | 25.4 | 19.8 | 6.2 |
| 2L31C11 | RL31/C | 8 | 1/4 | 14 | 15.4 | 13.5 | 25.4 | 23.6 | 8.5 |
| 2L31C12 | RL31/C | 8 | 3/8 | 17 | 19.2 | 13.8 | 23.6 | 27.1 | 9 |
| 2L31C13 | RL31/C | 10 | 1/4 | 14 | 15.4 | 16 | 27.2 | 26.3 | 8.5 |
| 2L31C14 | RL31/C | 10 | 3/8 | 17 | 19.2 | 16 | 27.2 | 27.1 | 9 |
| 2031C15 | RL31/C | 12 | 3/8 | 17 | 19.2 | 20 | 30 | 27.1 | 9 |
| 2031C16 | RL31/C | 12 | 1/2 | 22 | 24.6 | 20 | 30 | 31.9 | 11 |



CENTRAL TEE, MALE, CYLINDRICAL, ROTARY (R32)

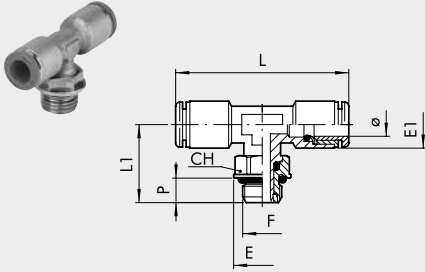

| Code | Ref. | Ø | F | CH | E | EI | L | LI | P |
|---------|------|----|-----|----|-----|------|------|------|----|
| 2L32001 | RL32 | 4 | M5 | 9 | 9.9 | 9.5 | 37.2 | 15.3 | 4 |
| 2L32002 | RL32 | 4 | 1/8 | 12 | 14 | 9.5 | 37.2 | 19.1 | 6 |
| 2L32003 | RL32 | 4 | 1/4 | 14 | 18 | 9.5 | 37.2 | 21.1 | 8 |
| 2032005 | R32 | 5 | 1/8 | 12 | 14 | 13.5 | 45.6 | 19.1 | 6 |
| 2L32004 | RL32 | 6 | M5 | 9 | 9.9 | 11.8 | 43.8 | 15.3 | 4 |
| 2L32008 | RL32 | 6 | 1/8 | 12 | 14 | 11.8 | 43.8 | 19.1 | 6 |
| 2L32009 | RL32 | 6 | 1/4 | 14 | 18 | 11.8 | 43.8 | 21.1 | 8 |
| 2L32010 | RL32 | 8 | 1/8 | 12 | 14 | 13.5 | 50.8 | 19.1 | 6 |
| 2L32011 | RL32 | 8 | 1/4 | 14 | 18 | 13.5 | 50.8 | 21.1 | 8 |
| 2L32012 | RL32 | 8 | 3/8 | 17 | 22 | 13.8 | 47.2 | 27.1 | 9 |
| 2L32013 | RL32 | 10 | 1/4 | 14 | 18 | 16 | 44.4 | 21.8 | 8 |
| 2L32014 | RL32 | 10 | 3/8 | 17 | 22 | 16 | 44.4 | 27.1 | 9 |
| 2032017 | RL32 | 12 | 3/8 | 17 | 22 | 20 | 60 | 27.1 | 9 |
| 2032018 | RL32 | 12 | 1/2 | 22 | 26 | 20 | 60 | 30.7 | 11 |
| 2032019 | RL32 | 14 | 1/2 | 22 | 26 | 21.3 | 66 | 32.3 | 11 |

CENTRAL TEE, MALE, CONICAL, ROTARY (R32C)

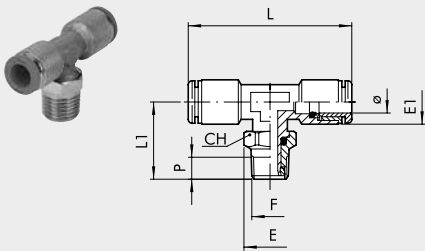

| Code | Ref. | Ø | F | CH | E | EI | L | LI | P |
|---------|--------|----|-----|----|------|------|------|------|-----|
| 2L32C02 | RL32/C | 4 | 1/8 | 12 | 13.3 | 9.5 | 37.2 | 19.8 | 6.2 |
| 2L32C03 | RL32/C | 4 | 1/4 | 14 | 15.4 | 9.5 | 37.2 | 22.6 | 8.5 |
| 2L32C08 | RL32/C | 6 | 1/8 | 12 | 13.3 | 11.8 | 43.8 | 19.8 | 6.2 |
| 2L32C09 | RL32/C | 6 | 1/4 | 14 | 15.4 | 11.8 | 43.8 | 22.6 | 8.5 |
| 2L32C10 | RL32/C | 8 | 1/8 | 12 | 13.3 | 13.5 | 50.8 | 19.8 | 6.2 |
| 2L32C11 | RL32/C | 8 | 1/4 | 14 | 15.4 | 13.5 | 50.8 | 23.6 | 8.5 |
| 2L32C12 | RL32/C | 8 | 3/8 | 17 | 19.2 | 13.8 | 47.2 | 27.1 | 9 |
| 2L32C13 | RL32/C | 10 | 1/4 | 14 | 15.4 | 16 | 44.4 | 26.3 | 8.5 |
| 2L32C14 | RL32/C | 10 | 3/8 | 17 | 19.2 | 16 | 44.4 | 27.1 | 9 |

LATERAL TEE, MALE, CYLINDRICAL, ROTARY (R38)

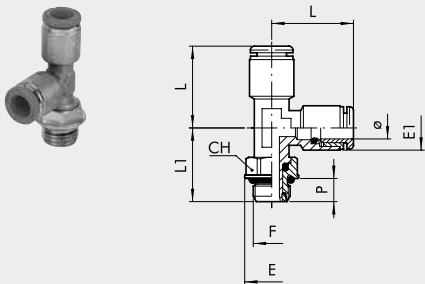

| Code | Ref. | Ø | F | CH | E | EI | L | LI | P |
|---------|------|----|-----|----|----|------|------|------|----|
| 2L38002 | RL38 | 4 | 1/8 | 12 | 14 | 9.5 | 18.6 | 19.1 | 6 |
| 2038005 | R38 | 5 | 1/8 | 12 | 14 | 13.5 | 22.8 | 19.1 | 6 |
| 2L38008 | RL38 | 6 | 1/8 | 12 | 14 | 11.5 | 21.9 | 19.1 | 6 |
| 2L38009 | RL38 | 6 | 1/4 | 14 | 18 | 11.5 | 21.9 | 21.1 | 8 |
| 2L38010 | RL38 | 8 | 1/8 | 12 | 14 | 13.5 | 25.4 | 19.1 | 6 |
| 2L38011 | RL38 | 8 | 1/4 | 14 | 18 | 13.5 | 25.4 | 22.1 | 8 |
| 2L38013 | RL38 | 10 | 1/4 | 14 | 18 | 16 | 27.2 | 21.8 | 8 |
| 2L38014 | RL38 | 10 | 3/8 | 17 | 22 | 16 | 27.2 | 27.1 | 9 |
| 2038015 | RL38 | 12 | 3/8 | 17 | 22 | 20 | 30 | 27.1 | 9 |
| 2038016 | RL38 | 12 | 1/2 | 22 | 26 | 20 | 30 | 30.7 | 11 |

ELBOW, MALE, CONICAL (R39C)

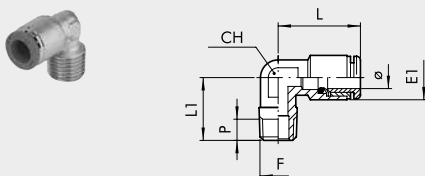

| Code | Ref. | Ø | F | CH | EI | L | LI | P | |
|---------|--------|----|-----------------|----|----|------|------|------|-----|
| 2L39C02 | RL39/C | 4 | 1/8 | | 10 | 9.5 | 18.6 | 16 | 6.2 |
| 2L39C08 | RL39/C | 6 | 1/8 | | 10 | 11.8 | 21.9 | 16 | 6.2 |
| 2L39C09 | RL39/C | 6 | 1/4 | | 10 | 11.8 | 21.9 | 18.5 | 8.5 |
| 2039Z07 | RL39/Z | 6 | 12x1 conical | | 10 | 11.8 | 21.9 | 17.5 | 7 |
| 2039Z08 | RL39/Z | 6 | 12x1.25 conical | | 10 | 11.8 | 21.9 | 17.5 | 7 |
| 2L39C10 | RL39/C | 8 | 1/8 | | 10 | 13.5 | 25.4 | 16 | 6.2 |
| 2L39C11 | RL39/C | 8 | 1/4 | | 10 | 13.5 | 25.4 | 18.5 | 8.5 |
| 2L39C13 | RL39/C | 10 | 1/4 | | 14 | 16 | 27.2 | 22 | 8.5 |

BRASS PUSH-IN FITTINGS FOR mm TUBES AND G (BSP) or METRIC THREAD

FITTINGS

G
BSP

CROSS FITTING (R40)

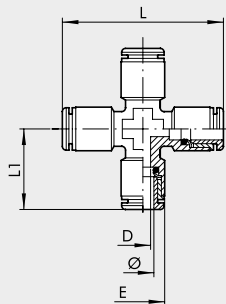

| Code | Ref. | Ø | D | E | L | L1 |
|---------|------|---|-----|------|------|------|
| 2L40001 | RL40 | 4 | 3 | 9.5 | 37.2 | 18.6 |
| 2L40003 | RL40 | 6 | 4.5 | 11.3 | 43.8 | 21.9 |
| 2L40004 | RL40 | 8 | 6.5 | 14 | 50.8 | 25.4 |

DUAL ROD SINGLE ROTARY RINGS (R50)

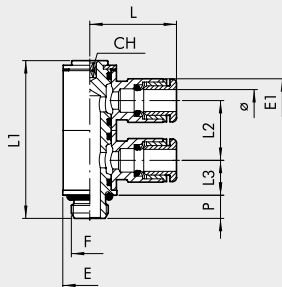

| Code | Ref. | Ø | F | CH | E | E1 | L | L1 | L2 | L3 | P |
|---------|------|----|-----|----|-----|------|------|------|------|------|---|
| 2L50001 | RL50 | 4 | M5 | 2 | 9.5 | 9.5 | 20.2 | 30.3 | 11.5 | 6.8 | 4 |
| 2L50002 | RL50 | 4 | 1/8 | 3 | 14 | 9.5 | 20.2 | 40.9 | 15.5 | 9.1 | 6 |
| 2033002 | R33 | 5 | 1/8 | 5 | 14 | 12 | 25 | 42 | 15 | 10.5 | 6 |
| 2L50007 | RL50 | 6 | M5 | 2 | 9.5 | 11.3 | 23.5 | 30.3 | 11.5 | 6.8 | 4 |
| 2L50008 | RL50 | 6 | 1/8 | 3 | 14 | 11.3 | 23.5 | 40.9 | 15.5 | 9.1 | 6 |
| 2L50009 | RL50 | 6 | 1/4 | 4 | 18 | 11.5 | 23 | 47 | 17.2 | 10.2 | 8 |
| 2L50010 | RL50 | 8 | 1/8 | 3 | 14 | 13.8 | 24.8 | 40.9 | 15.5 | 9.1 | 6 |
| 2L50011 | RL50 | 8 | 1/4 | 4 | 18 | 13.8 | 26.5 | 47 | 17.2 | 10.2 | 8 |
| 2L50013 | RL50 | 10 | 1/4 | 4 | 18 | 16.5 | 31.4 | 47 | 17.2 | 10.2 | 8 |

DUAL ROD DUAL ROTARY RINGS (R51)

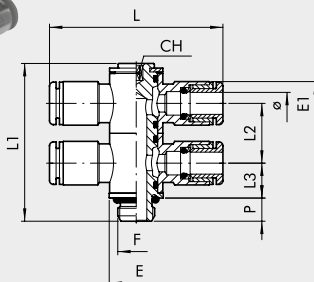

| Code | Ref. | Ø | F | CH | E | E1 | L | L1 | L2 | L3 | P |
|---------|------|----|-----|----|-----|------|------|------|------|------|---|
| 2L51001 | RL51 | 4 | M5 | 2 | 9.5 | 9.5 | 40.4 | 30.3 | 11.5 | 6.8 | 4 |
| 2L51002 | RL51 | 4 | 1/8 | 3 | 14 | 9.5 | 40.4 | 40.9 | 15.5 | 9.1 | 6 |
| 2L51007 | RL51 | 6 | M5 | 2 | 9.5 | 11.3 | 47 | 30.3 | 11.5 | 6.8 | 4 |
| 2L51008 | RL51 | 6 | 1/8 | 3 | 14 | 11.3 | 47 | 40.9 | 15.5 | 9.1 | 6 |
| 2L51009 | RL51 | 6 | 1/4 | 4 | 18 | 11.5 | 46 | 47 | 17.2 | 10.2 | 8 |
| 2L51010 | RL51 | 8 | 1/8 | 3 | 14 | 13.8 | 49.6 | 40.9 | 15.5 | 9.1 | 6 |
| 2L51011 | RL51 | 8 | 1/4 | 4 | 18 | 13.8 | 53 | 47 | 17.2 | 10.2 | 8 |
| 2L51013 | RL51 | 10 | 1/4 | 4 | 18 | 16.5 | 62.8 | 47 | 17.2 | 10.2 | 8 |

TRIPLE ROD SINGLE ROTARY RINGS (R52)

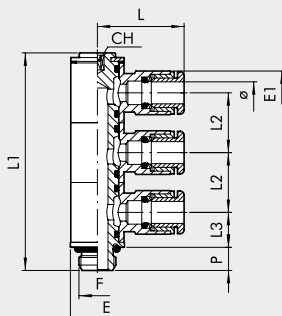

| Code | Ref. | Ø | F | CH | E | E1 | L | L1 | L2 | L3 | P |
|---------|------|----|-----|----|----|------|------|------|------|------|---|
| 2L52002 | RL52 | 4 | 1/8 | 3 | 14 | 9.5 | 20.2 | 56.7 | 15.5 | 9.1 | 6 |
| 2L52008 | RL52 | 6 | 1/8 | 3 | 14 | 11.3 | 23.5 | 56.7 | 15.5 | 9.1 | 6 |
| 2L52009 | RL52 | 6 | 1/4 | 4 | 18 | 11.5 | 23 | 64.3 | 17.2 | 10.2 | 8 |
| 2L52010 | RL52 | 8 | 1/8 | 3 | 14 | 13.8 | 24.8 | 56.7 | 15.5 | 9.1 | 6 |
| 2L52011 | RL52 | 8 | 1/4 | 4 | 18 | 13.8 | 26.5 | 64.3 | 17.2 | 10.2 | 8 |
| 2L52013 | RL52 | 10 | 1/4 | 4 | 18 | 16.5 | 31.4 | 64.3 | 17.2 | 10.2 | 8 |



TRIPLE ROD DUAL ROTARY RINGS (R53)

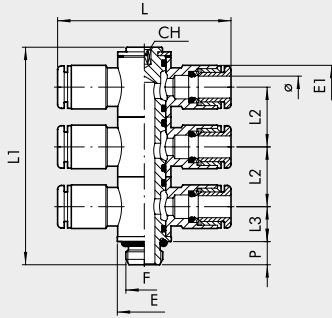

| Code | Ref. | Ø | F | CH | E | EI | L | L1 | L2 | L3 | P |
|---------|------|----|-----|----|----|------|------|------|------|------|---|
| 2L53002 | RL53 | 4 | 1/8 | 3 | 14 | 9.5 | 40.2 | 56.7 | 15.5 | 9.1 | 6 |
| 2L53008 | RL53 | 6 | 1/8 | 3 | 14 | 11.3 | 47 | 56.7 | 15.5 | 9.1 | 6 |
| 2L53009 | RL53 | 6 | 1/4 | 4 | 18 | 11.5 | 46 | 64.3 | 17.2 | 10.2 | 8 |
| 2L53010 | RL53 | 8 | 1/8 | 3 | 14 | 13.8 | 49.6 | 56.7 | 15.5 | 9.1 | 6 |
| 2L53011 | RL53 | 8 | 1/4 | 4 | 18 | 13.8 | 53 | 64.3 | 17.2 | 10.2 | 8 |
| 2L53013 | RL53 | 10 | 1/4 | 4 | 18 | 16.5 | 62.8 | 64.3 | 17.2 | 10.2 | 8 |

MALE ROD, SINGLE SWIVEL RING (R54)

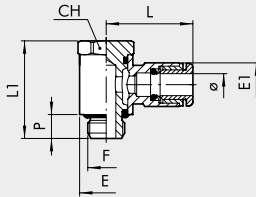

| Code | Ref. | Ø | F | CH | E | EI | L | L1 | P |
|---------|------|----|-----|----|-----|------|------|------|-----|
| 2L54001 | RL54 | 4 | M5 | 9 | 9.5 | 9.5 | 20.2 | 18.7 | 4.5 |
| 2L54002 | RL54 | 4 | 1/8 | 13 | 14 | 9.5 | 21.3 | 25.3 | 6.2 |
| 2L54007 | RL54 | 6 | M5 | 9 | 9.5 | 11.3 | 23.5 | 18.7 | 4.5 |
| 2L54008 | RL54 | 6 | 1/8 | 13 | 14 | 11.5 | 23 | 25.3 | 6.2 |
| 2L54009 | RL54 | 6 | 1/4 | 16 | 18 | 11.5 | 24.5 | 29.2 | 8 |
| 2L54010 | RL54 | 8 | 1/8 | 13 | 14 | 13.8 | 24.8 | 25.3 | 6.2 |
| 2L54011 | RL54 | 8 | 1/4 | 16 | 18 | 13.8 | 26.5 | 29.2 | 8 |
| 2L54012 | RL54 | 8 | 3/8 | 20 | 21 | 13.8 | 28.5 | 35.4 | 9 |
| 2L54013 | RL54 | 10 | 1/4 | 16 | 18 | 16.5 | 31.4 | 29.2 | 8 |
| 2L54014 | RL54 | 10 | 3/8 | 20 | 21 | 16 | 32.8 | 35.4 | 9 |
| 2L54018 | RL54 | 12 | 1/4 | 16 | 18 | 19.5 | 33 | 29.2 | 8 |
| 2L54016 | RL54 | 12 | 3/8 | 20 | 21 | 19.5 | 35.3 | 35.4 | 9 |
| 2L54017 | RL54 | 12 | 1/2 | 25 | 26 | 19.5 | 37 | 40 | 11 |
| 2L54020 | RL54 | 14 | 1/2 | 25 | 26 | 22 | 35 | 40 | 11 |

MALE ROD, DUAL SWIVEL RING (R55)

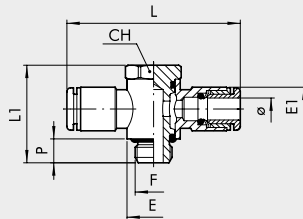

| Code | Ref. | Ø | F | CH | E | EI | L | L1 | P |
|---------|------|----|-----|----|-----|------|------|------|-----|
| 2L55001 | RL55 | 4 | M5 | 9 | 9.5 | 9.5 | 40.4 | 18.7 | 4.5 |
| 2L55002 | RL55 | 4 | 1/8 | 13 | 14 | 9.5 | 42.6 | 25.3 | 6 |
| 2L55007 | RL55 | 6 | M5 | 9 | 9.5 | 11.3 | 47 | 18.7 | 4.5 |
| 2L55008 | RL55 | 6 | 1/8 | 13 | 14 | 11.5 | 46 | 25.3 | 6 |
| 2L55009 | RL55 | 6 | 1/4 | 16 | 18 | 11.5 | 49 | 29.2 | 8 |
| 2L55010 | RL55 | 8 | 1/8 | 13 | 14 | 13.8 | 49.6 | 25.3 | 6 |
| 2L55011 | RL55 | 8 | 1/4 | 16 | 18 | 13.8 | 53 | 29.2 | 8 |
| 2L55012 | RL55 | 8 | 3/8 | 20 | 21 | 13.8 | 57 | 35.4 | 9 |
| 2L55013 | RL55 | 10 | 1/4 | 16 | 18 | 16.5 | 62.8 | 29.2 | 8 |
| 2L55014 | RL55 | 10 | 3/8 | 20 | 21 | 16 | 65.6 | 35.4 | 9 |
| 2L55018 | RL55 | 12 | 1/4 | 16 | 18 | 19.5 | 66 | 29.2 | 8 |
| 2L55016 | RL55 | 12 | 3/8 | 20 | 21 | 19.5 | 70.6 | 35.4 | 9 |
| 2L55017 | RL55 | 12 | 1/2 | 25 | 26 | 19.5 | 74 | 40 | 11 |

BRASS PUSH-IN FITTINGS FOR mm TUBES AND G (BSP) or METRIC THREAD

FITTINGS



DUAL ROD, MALE SINGLE SWIVEL RINGS (R56)

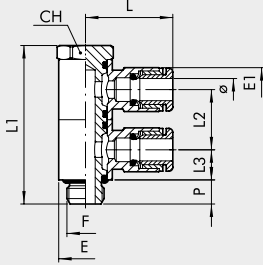

| Code | Ref. | Ø | F | CH | E | E1 | L | L1 | L2 | L3 | P |
|---------|------|----|-----|----|-----|------|------|------|------|------|-----|
| 2L56001 | RL56 | 4 | M5 | 9 | 9.5 | 9.5 | 20.2 | 30.2 | 11.5 | 5.8 | 4.5 |
| 2L56002 | RL56 | 4 | 1/8 | 13 | 14 | 9.5 | 21.3 | 41 | 15.5 | 7.8 | 6 |
| 2L56007 | RL56 | 6 | M5 | 9 | 9.5 | 11.3 | 23.5 | 30.2 | 11.5 | 5.8 | 4.5 |
| 2L56008 | RL56 | 6 | 1/8 | 13 | 14 | 11.5 | 23 | 41 | 15.5 | 7.8 | 6 |
| 2L56009 | RL56 | 6 | 1/4 | 16 | 18 | 11.5 | 24.5 | 46.4 | 17.2 | 8.6 | 8 |
| 2L56010 | RL56 | 8 | 1/8 | 13 | 14 | 13.8 | 24.8 | 41 | 15.5 | 7.8 | 6 |
| 2L56011 | RL56 | 8 | 1/4 | 16 | 18 | 13.8 | 26.5 | 46.4 | 17.2 | 8.6 | 8 |
| 2L56012 | RL56 | 8 | 3/8 | 20 | 21 | 13.8 | 28.5 | 56.8 | 21.4 | 10.7 | 9 |
| 2L56013 | RL56 | 10 | 1/4 | 16 | 18 | 16.5 | 31.4 | 46.4 | 17.2 | 8.6 | 8 |
| 2L56014 | RL56 | 10 | 3/8 | 20 | 21 | 16 | 32.8 | 56.8 | 21.4 | 10.7 | 9 |
| 2L56016 | RL56 | 12 | 3/8 | 20 | 21 | 19.5 | 35.3 | 56.8 | 21.4 | 10.7 | 9 |
| 2L56017 | RL56 | 12 | 1/2 | 25 | 26 | 19.5 | 37 | 64 | 24 | 12 | 11 |
| 2L56020 | RL56 | 14 | 1/2 | 25 | 26 | 22 | 35 | 64 | 24 | 12 | 11 |

DUAL ROD, MALE DUAL SWIVEL RINGS (R57)

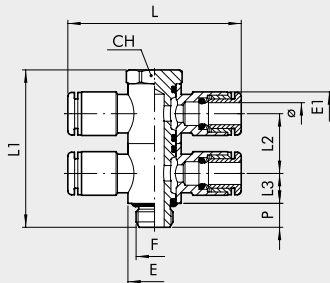

| Code | Ref. | Ø | F | CH | E | E1 | L | L1 | L2 | L3 | P |
|---------|------|----|-----|----|-----|------|------|------|------|------|-----|
| 2L57001 | RL57 | 4 | M5 | 9 | 9.5 | 9.5 | 40.4 | 30.2 | 11.5 | 5.8 | 4.5 |
| 2L57002 | RL57 | 4 | 1/8 | 13 | 14 | 9.5 | 42.6 | 41 | 15.5 | 7.8 | 6 |
| 2L57007 | RL57 | 6 | M5 | 9 | 9.5 | 11.3 | 47 | 30.2 | 11.5 | 5.8 | 4.5 |
| 2L57008 | RL57 | 6 | 1/8 | 13 | 14 | 11.5 | 46 | 41 | 15.5 | 7.8 | 6 |
| 2L57009 | RL57 | 6 | 1/4 | 16 | 18 | 11.5 | 49 | 46.4 | 17.2 | 8.6 | 8 |
| 2L57010 | RL57 | 8 | 1/8 | 13 | 14 | 13.8 | 49.6 | 41 | 15.5 | 7.8 | 6 |
| 2L57011 | RL57 | 8 | 1/4 | 16 | 18 | 13.8 | 53 | 46.4 | 17.2 | 8.6 | 8 |
| 2L57012 | RL57 | 8 | 3/8 | 20 | 21 | 13.8 | 57 | 56.8 | 21.4 | 10.7 | 9 |
| 2L57013 | RL57 | 10 | 1/4 | 16 | 18 | 16.5 | 62.8 | 46.4 | 17.2 | 8.6 | 8 |
| 2L57014 | RL57 | 10 | 3/8 | 20 | 21 | 16 | 65.6 | 56.8 | 21.4 | 10.7 | 9 |
| 2L57016 | RL57 | 12 | 3/8 | 20 | 21 | 19.5 | 70.6 | 56.8 | 21.4 | 10.7 | 9 |
| 2L57017 | RL57 | 12 | 1/2 | 25 | 26 | 19.5 | 74 | 64 | 24 | 12 | 11 |

TAPERED THREAD BRASS FITTINGS WITH PTFE

Metal Work can supply fittings with a tapered thread coated in polytetrafluorethylene. This system provides the pneumatic seal between the fitting and the female thread. It is therefore not necessary to add other sealing systems during assembly, such as adhesives or Teflon tape. This significantly reduces assembly times. The physical and technical features of the material used ensure that the properties are maintained through time and in a wide range of operating temperatures. This coating can be used with push-in fittings type R1C, R31C, R32C and R39C that have a G1/8 to G1/2 taper thread.

KEY TO CODES

Fittings with a PTFE thread have the same code as the standard fitting, with the addition of the suffix **T**. For example RL1C 8 3/8 fitting has code **2L01C11**, so the PTFE version has code **2L01C11T**.

UNF NPT BRASS PUSH-IN FITTINGS FOR INCH TUBES AND UNF or NPT THREAD

STRAIGHT, MALE (RU1)

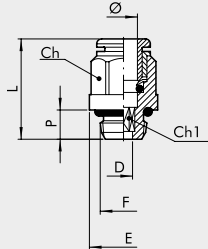

| Code | Ref. | Ø | F | Ch | | Ch1 | | P | L | D | E |
|---------|------|------|-----------|-------|----|-------|----|-----|------|----|------|
| | | | | Inc | mm | Inc | mm | | | | |
| 2U01A02 | RU1 | 1/8 | 10-32 UNF | — | — | 5/64 | 2 | 3.5 | 13 | 2 | 5.9 |
| 2U01A03 | RU1 | 1/8 | 1/8 NPT | 5/16 | 8 | 5/64 | 2 | 6 | 13.7 | 2 | 13 |
| 2U01001 | RU1 | 5/32 | 10-32 UNF | — | — | 5/64 | 2 | 3.5 | 20.3 | 2 | 9 |
| 2U01002 | RU1 | 5/32 | 1/8 NPT | 0.394 | 10 | 0.118 | 3 | 6 | 18 | 3 | 13 |
| 2U01003 | RU1 | 5/32 | 1/4 NPT | 0.394 | 10 | 0.118 | 3 | 8 | 19.8 | 3 | 16.4 |
| 2U01000 | RU1 | 1/4 | 10-32 UNF | — | — | 5/64 | 2 | 3.5 | 21.9 | 2 | 11 |
| 2U01007 | RU1 | 1/4 | 1/8 NPT | 0.472 | 12 | 0.157 | 4 | 6 | 21.6 | 4 | 13 |
| 2U01008 | RU1 | 1/4 | 1/4 NPT | 0.472 | 12 | 0.157 | 4 | 8 | 20.3 | 4 | 16.4 |
| 2U01020 | RU1 | 1/4 | 3/8 NPT | 0.472 | 12 | 0.157 | 4 | 9 | 21.3 | 4 | 20 |
| 2U01009 | RU1 | 5/16 | 1/8 NPT | 0.512 | 13 | 0.197 | 5 | 6 | 25.4 | 5 | 14 |
| 2U01010 | RU1 | 5/16 | 1/4 NPT | 0.551 | 14 | 0.236 | 6 | 8 | 24.4 | 6 | 16.4 |
| 2U01011 | RU1 | 5/16 | 3/8 NPT | 0.551 | 14 | 0.236 | 6 | 9 | 22.8 | 6 | 20 |
| 2U01012 | RU1 | 3/8 | 1/4 NPT | 5/8 | 16 | 0.276 | 7 | 8 | 29.2 | 7 | 17.7 |
| 2U01013 | RU1 | 3/8 | 3/8 NPT | 5/8 | 16 | 5/16 | 8 | 9 | 26.5 | 8 | 20 |
| 2U01021 | RU1 | 3/8 | 1/2 NPT | 5/8 | 16 | 5/16 | 8 | 11 | 30 | 8 | 24.5 |
| 2U01014 | RU1 | 1/2 | 3/8 NPT | 0.866 | 22 | 0.394 | 10 | 9 | 32.5 | 10 | 20 |
| 2U01015 | RU1 | 1/2 | 1/2 NPT | 0.866 | 22 | 0.394 | 10 | 11 | 30 | 10 | 24.5 |

STRAIGHT, FEMALE (RU2)

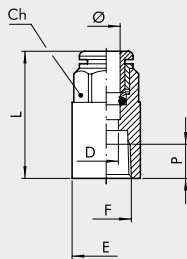

| Code | Ref. | Ø | F | Ch | | P | L | D | E |
|---------|------|------|---------|-------|----|---|------|-----|----|
| | | | | Inc | mm | | | | |
| 2U02A03 | RU2 | 1/8 | 1/8 NPT | 5/16 | 8 | 7 | 20.8 | 2.3 | 14 |
| 2U02001 | RU2 | 5/32 | 1/8 NPT | 0.394 | 10 | 7 | 26.2 | 3 | 14 |
| 2U02002 | RU2 | 5/32 | 1/4 NPT | 0.394 | 10 | 7 | 28.6 | 3 | 17 |
| 2U02005 | RU2 | 1/4 | 1/8 NPT | 0.472 | 12 | 7 | 27.1 | 5 | 14 |
| 2U02006 | RU2 | 1/4 | 1/4 NPT | 0.472 | 12 | 7 | 29.3 | 5 | 17 |
| 2U02007 | RU2 | 5/16 | 1/8 NPT | 0.512 | 13 | 7 | 28.1 | 7 | 14 |
| 2U02008 | RU2 | 5/16 | 1/4 NPT | 0.551 | 14 | 7 | 30 | 7 | 17 |

STRAIGHT, INTERMEDIATE (RU3)

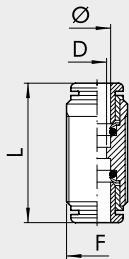

| Code | Ref. | Ø | F | L | D |
|---------|------|------|---------|------|-----|
| 2003A01 | R3 | 1/8 | M8x0.75 | 18.4 | 2 |
| 2L03001 | RL3 | 5/32 | M11x1 | 30.6 | 2.5 |
| 2U03003 | RU3 | 1/4 | M13x1 | 33 | 4.5 |
| 2L03004 | RL3 | 5/16 | M15x1 | 35.7 | 6.5 |
| 2U03005 | RU3 | 3/8 | M17x1 | 39.8 | 8 |
| 2U03006 | RU3 | 1/2 | M22x1 | 43.2 | 10 |

ELBOW, INTERMEDIATE (RU4)

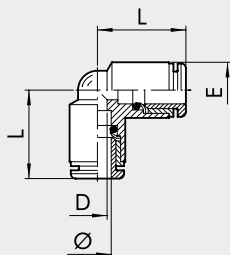

| Code | Ref. | Ø | L | D | E |
|---------|------|------|------|-----|------|
| 2004A01 | R4 | 1/8 | 10.4 | 2 | 6.3 |
| 2L04001 | RL4 | 5/32 | 16.7 | 2.5 | 9.5 |
| 2U04003 | RU4 | 1/4 | 19 | 4.5 | 11.5 |
| 2L04004 | RL4 | 5/16 | 21.3 | 6.5 | 13.5 |
| 2U04005 | RU4 | 3/8 | 23.6 | 8 | 15.5 |
| 2U04006 | RU4 | 1/2 | 27.2 | 11 | 20.5 |

BRASS PUSH-IN FITTINGS FOR INCH TUBES AND UNF or NPT THREAD

FITTINGS

UNF
NPT

TEE, INTERMEDIATE (RU5)

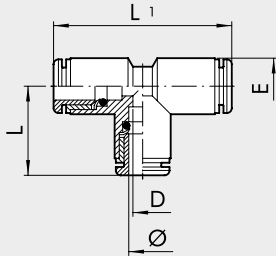

| Code | Ref. | Ø | L | L1 | D | E |
|---------|------|------|------|------|-----|------|
| 2005A01 | R5 | 1/8 | 10.4 | 20.8 | 2 | 6.3 |
| 2U05001 | RL5 | 5/32 | 16.7 | 33.4 | 2.5 | 9.5 |
| 2U05003 | RU5 | 1/4 | 19 | 38 | 4.5 | 11.5 |
| 2U05004 | RL5 | 5/16 | 21.3 | 42.6 | 6.5 | 13.5 |
| 2U05005 | RU5 | 3/8 | 23.6 | 47.2 | 8 | 15.5 |
| 2U05006 | RU5 | 1/2 | 27.2 | 54.4 | 11 | 20.5 |

THREADED ADAPTER (RU6)

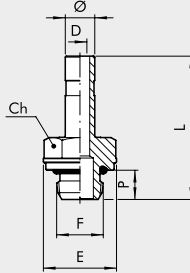

| Code | Ref. | Ø | F | Ch | | P | L | D | E |
|---------|------|------|-----------|-------|----|-----|------|------|------|
| | | | | Inc | mm | | | | |
| 2U06A01 | RU6 | 1/8 | 10-32 UNF | 0.197 | 5 | 3.5 | 18.6 | 2 | 5.8 |
| 2U06A02 | RU6 | 1/8 | 1/8 NPT | 0.472 | 12 | 6 | 22.6 | 2 | 13 |
| 2U06001 | RU6 | 5/32 | 10-32 UNF | 5/16 | 8 | 4 | 25.2 | 2 | 9 |
| 2U06002 | RU6 | 5/32 | 1/8 NPT | 0.472 | 12 | 6 | 27.7 | 2.5 | 13 |
| 2U06003 | RU6 | 5/32 | 1/4 NPT | 0.551 | 14 | 8 | 30.2 | 2.5 | 16.4 |
| 2U06000 | RU6 | 1/4 | 10-32 UNF | 5/16 | 8 | 4 | 25.7 | 2 | 9 |
| 2U06007 | RU6 | 1/4 | 1/8 NPT | 0.472 | 12 | 6 | 28.2 | 4 | 13 |
| 2U06008 | RU6 | 1/4 | 1/4 NPT | 0.551 | 14 | 8 | 30.5 | 4 | 16.4 |
| 2U06020 | RU6 | 1/4 | 3/8 NPT | 0.669 | 17 | 9 | 33.3 | 4 | 20 |
| 2U06009 | RU6 | 5/16 | 1/8 NPT | 0.472 | 12 | 6 | 29.2 | 5.5 | 13 |
| 2U06010 | RU6 | 5/16 | 1/4 NPT | 0.551 | 14 | 8 | 31.5 | 6 | 16.4 |
| 2U06011 | RU6 | 5/16 | 3/8 NPT | 0.669 | 17 | 9 | 34.3 | 6 | 20 |
| 2U06012 | RU6 | 3/8 | 1/4 NPT | 0.551 | 14 | 8 | 34.8 | 7.3 | 16.4 |
| 2U06013 | RU6 | 3/8 | 3/8 NPT | 0.669 | 17 | 9 | 37.6 | 7.3 | 20 |
| 2U06022 | RU6 | 3/8 | 1/2 NPT | 0.748 | 19 | 11 | 41.2 | 7.3 | 24.5 |
| 2U06014 | RU6 | 1/2 | 3/8 NPT | 0.669 | 17 | 9 | 39.4 | 10.5 | 20 |
| 2U06015 | RU6 | 1/2 | 1/2 NPT | 0.748 | 19 | 11 | 43.7 | 10.5 | 24.5 |

EXTENSION (RU7)

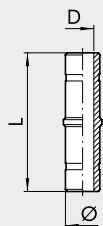

| Code | Ref. | Ø | L | D |
|---------|------|------|------|------|
| 2007001 | R7 | 5/32 | 34 | 2 |
| 2U07003 | RU7 | 1/4 | 35.5 | 4 |
| 2U07004 | RL7 | 5/16 | 37.5 | 6 |
| 2U07005 | RU7 | 3/8 | 44 | 7.3 |
| 2U07006 | RU7 | 1/2 | 50.8 | 10.5 |

REDUCER (RU8)

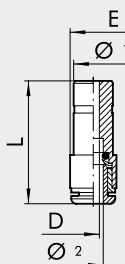

| Code | Ref. | Ø 1 | Ø 2 | L | D | E |
|---------|------|------|------|------|-----|------|
| 2008A02 | R8 | 5/32 | 1/8 | 18.4 | 2 | 5 |
| 2U08002 | RU8 | 1/4 | 5/32 | 30.6 | 2.5 | 11 |
| 2U08004 | RL8 | 5/16 | 5/32 | 33 | 4.5 | 12 |
| 2U08006 | RU8 | 5/16 | 1/4 | 35.7 | 6.5 | 13.5 |
| 2U08007 | RU8 | 3/8 | 1/4 | 39.8 | 8 | 17 |
| 2U08010 | RU8 | 1/2 | 1/4 | 43.2 | 10 | 19 |
| 2U08011 | RU8 | 1/2 | 5/16 | 35.9 | 7 | 14.5 |
| 2U08015 | RU8 | 1/2 | 3/8 | 41.3 | 8 | 16 |

UNF
NPT

PLUG (RU9)

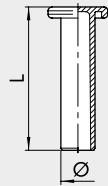

| Code | Ref. | Ø | L |
|---------|------|------|------|
| 2L10A01 | RL9T | 1/8 | 19.6 |
| 2L10001 | RL9T | 5/32 | 27 |
| 2U10003 | RU9 | 1/4 | 29.8 |
| 2L10004 | RL9T | 5/16 | 33.6 |
| 2U10005 | RU9 | 3/8 | 36.8 |
| 2U10006 | RU9 | 1/2 | 39.1 |

STRAIGHT, INTERMEDIATE, BULKMTAD (RU10)

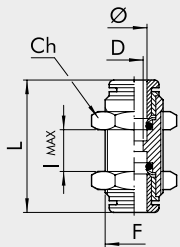

| Code | Ref. | Ø | F | Ch | | L | D | lmax |
|---------|------|------|---------|-------|----|------|-----|------|
| | | | | Inc | mm | | | |
| 2011A01 | RI0 | 1/8 | M8x0.75 | 0.394 | 10 | 18.4 | 2 | 5 |
| 2L11001 | RL10 | 5/32 | M11x1 | 0.512 | 13 | 30.6 | 2.5 | 11 |
| 2U11003 | RU10 | 1/4 | M13x1 | 5/8 | 16 | 33 | 4.5 | 12 |
| 2L11004 | RL10 | 5/16 | M15x1 | 0.669 | 17 | 35.7 | 6.5 | 13.5 |
| 2U11005 | RU10 | 3/8 | M17x1 | 0.787 | 20 | 39.8 | 8 | 17 |
| 2U11006 | RU10 | 1/2 | M22x1 | 0.984 | 25 | 43.2 | 10 | 19 |

ROD, MALE SINGLE ROTARY RING (RU15)

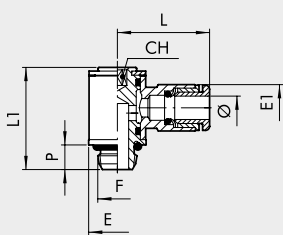

| Code | Ref. | Ø | F | Ch | | P | L | LI | E | EI |
|---------|------|------|-----------|-------|----|-----|------|------|-----|------|
| | | | | Inc | mm | | | | | |
| 2U14104 | RU15 | 1/8 | 10-32 UNF | 5/64 | 2 | 3.5 | 12.7 | 13.7 | 5.8 | 7 |
| 2U14001 | RU15 | 5/32 | 10-32 UNF | 5/64 | 2 | 3.5 | 20.2 | 18.8 | 9.5 | 9.5 |
| 2U14002 | RU15 | 5/32 | 1/8 NPT | 0.118 | 3 | 6 | 21.3 | 25.6 | 14 | 9.5 |
| 2U14106 | RU15 | 1/4 | 10-32 UNF | 5/64 | 2 | 3.5 | 23.5 | 18.8 | 9.5 | 12 |
| 2U14005 | RU15 | 1/4 | 1/8 NPT | 0.118 | 3 | 6 | 23 | 25.6 | 14 | 12 |
| 2U14007 | RU15 | 1/4 | 1/4 NPT | 5/32 | 4 | 8 | 24.5 | 29.8 | 18 | 12 |
| 2U14006 | RU15 | 5/16 | 1/8 NPT | 0.118 | 3 | 6 | 24.8 | 25.6 | 14 | 13.8 |
| 2U14008 | RU15 | 5/16 | 1/4 NPT | 5/32 | 4 | 8 | 26.5 | 29.8 | 18 | 13.8 |
| 2U14013 | RU15 | 5/16 | 3/8 NPT | 0.197 | 5 | 9 | 28.5 | 35.6 | 22 | 13.8 |
| 2U14009 | RU15 | 3/8 | 1/4 NPT | 5/32 | 4 | 8 | 31.7 | 29.8 | 18 | 16.5 |
| 2U14014 | RU15 | 3/8 | 3/8 NPT | 0.197 | 5 | 9 | 33.1 | 35.6 | 22 | 16 |
| 2U14011 | RU15 | 1/2 | 3/8 NPT | 0.197 | 5 | 9 | 36.6 | 35.6 | 22 | 20 |
| 2U14012 | RU15 | 1/2 | 1/2 NPT | 0.315 | 8 | 11 | 38.1 | 40.8 | 26 | 20 |

ROD, MALE DUAL ROTARY RING (RU16)

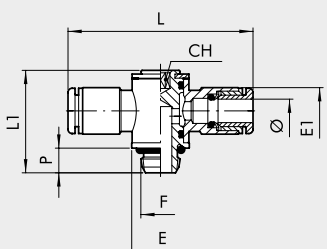

| Code | Ref. | Ø | F | Ch | | P | L | LI | E | EI |
|---------|------|------|-----------|-------|----|-----|------|------|-----|------|
| | | | | Inc | mm | | | | | |
| 2U15001 | RU16 | 5/32 | 10-32 UNF | 5/64 | 2 | 3.5 | 40.4 | 18.8 | 9.5 | 9.5 |
| 2U15002 | RU16 | 5/32 | 1/8 NPT | 5/64 | 2 | 6 | 42.6 | 25.6 | 14 | 9.5 |
| 2U15106 | RU16 | 1/4 | 10-32 UNF | 0.118 | 3 | 3.5 | 47 | 18.8 | 9.5 | 12 |
| 2U15005 | RU16 | 1/4 | 1/8 NPT | 5/64 | 2 | 6 | 46 | 25.6 | 14 | 12 |
| 2U15007 | RU16 | 1/4 | 1/4 NPT | 0.118 | 3 | 8 | 49 | 29.8 | 18 | 12 |
| 2U15006 | RU16 | 5/16 | 1/8 NPT | 5/32 | 4 | 6 | 49.6 | 25.6 | 14 | 13.8 |
| 2U15008 | RU16 | 5/16 | 1/4 NPT | 0.118 | 3 | 8 | 53 | 29.8 | 18 | 13.8 |
| 2U15013 | RU16 | 5/16 | 3/8 NPT | 5/32 | 4 | 9 | 57 | 35.6 | 22 | 13.8 |
| 2U15009 | RU16 | 3/8 | 1/4 NPT | 0.197 | 5 | 8 | 63.4 | 29.8 | 18 | 16.5 |
| 2U15014 | RU16 | 3/8 | 3/8 NPT | 5/32 | 4 | 9 | 66.2 | 35.6 | 22 | 16 |
| 2U15011 | RU16 | 1/2 | 3/8 NPT | 0.197 | 5 | 9 | 73.2 | 35.6 | 22 | 20 |
| 2U15012 | RU16 | 1/2 | 1/2 NPT | 0.315 | 8 | 11 | 78.2 | 40.8 | 26 | 20 |

BRASS PUSH-IN FITTINGS FOR INCH TUBES AND UNF or NPT THREAD

FITTINGS

UNF
NPT

ROTARY ELBOW, MALE (RU31)

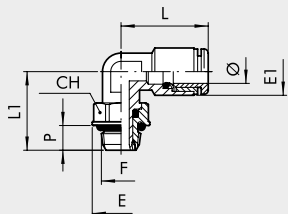

| Code | Ref. | Ø | F | Ch | | P | L | LI | E | EI |
|---------|------|------|-----------|-------|----|----|------|------|------|------|
| | | | | Inc | mm | | | | | |
| 2U31001 | RU31 | 5/32 | 10-32 UNF | 0.354 | 9 | 4 | 18.6 | 15.3 | 9.9 | 9.5 |
| 2U31002 | RU31 | 5/32 | 1/8 NPT | 0.472 | 12 | 6 | 18.6 | 19.1 | 13 | 9.5 |
| 2U31003 | RU31 | 5/32 | 1/4 NPT | 0.551 | 14 | 8 | 18.6 | 21.1 | 16.4 | 9.5 |
| 2U31007 | RU31 | 1/4 | 10-32 UNF | 0.354 | 9 | 4 | 21.9 | 15.3 | 9.9 | 11.8 |
| 2U31008 | RU31 | 1/4 | 1/8 NPT | 0.472 | 12 | 6 | 21.9 | 19.1 | 13 | 11.8 |
| 2U31009 | RU31 | 1/4 | 1/4 NPT | 0.551 | 14 | 8 | 21.9 | 21.1 | 16.4 | 11.8 |
| 2U31010 | RU31 | 5/16 | 1/8 NPT | 0.472 | 12 | 6 | 25.4 | 19.1 | 13 | 13.5 |
| 2U31011 | RU31 | 5/16 | 1/4 NPT | 0.551 | 14 | 8 | 25.4 | 21.1 | 16.4 | 13.5 |
| 2U31012 | RU31 | 5/16 | 3/8 NPT | 0.669 | 17 | 9 | 23.6 | 27.1 | 20 | 13.5 |
| 2U31013 | RU31 | 3/8 | 1/4 NPT | 0.551 | 14 | 8 | 27.5 | 24.5 | 16.4 | 16 |
| 2U31014 | RU31 | 3/8 | 3/8 NPT | 0.669 | 17 | 9 | 27.5 | 27.1 | 20 | 16 |
| 2U31015 | RU31 | 3/8 | 1/2 NPT | 0.866 | 22 | 11 | 27.5 | 30 | 24.5 | 16 |
| 2U31017 | RU31 | 1/2 | 3/8 NPT | 0.67 | 17 | 9 | 30.2 | 28.2 | 20 | 20 |
| 2U31018 | RU31 | 1/2 | 1/2 NPT | 0.866 | 22 | 11 | 30.2 | 30.5 | 24.5 | 20 |

CENTRAL TEE, MALE, ROTARY (RU32)

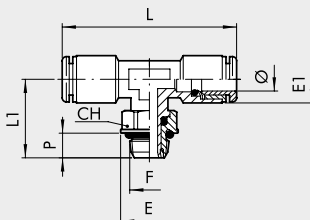

| Code | Ref. | Ø | F | Ch | | P | L | LI | E | EI |
|---------|------|------|-----------|-------|----|----|------|------|------|------|
| | | | | Inc | mm | | | | | |
| 2U32002 | RU32 | 5/32 | 1/8 NPT | 0.472 | 12 | 6 | 37.2 | 19.1 | 13 | 9.5 |
| 2U32003 | RU32 | 5/32 | 1/4 NPT | 0.551 | 14 | 8 | 37.2 | 21.1 | 16.4 | 9.5 |
| 2U32007 | RU32 | 1/4 | 10-32 UNF | 0.354 | 9 | 4 | 45 | 15.3 | 9.9 | 11.8 |
| 2U32008 | RU32 | 1/4 | 1/8 NPT | 0.472 | 12 | 6 | 45 | 19.1 | 13 | 11.8 |
| 2U32009 | RU32 | 1/4 | 1/4 NPT | 0.551 | 14 | 8 | 45 | 21.1 | 16.4 | 11.8 |
| 2U32010 | RU32 | 5/16 | 1/8 NPT | 0.472 | 12 | 6 | 50.8 | 19.1 | 13 | 13.5 |
| 2U32011 | RU32 | 5/16 | 1/4 NPT | 0.551 | 14 | 8 | 50.8 | 21.1 | 16.4 | 13.5 |
| 2U32012 | RU32 | 5/16 | 3/8 NPT | 0.669 | 17 | 9 | 47.2 | 27.1 | 20 | 13.5 |
| 2U32013 | RU32 | 3/8 | 1/4 NPT | 0.551 | 14 | 8 | 55 | 24.5 | 16.4 | 16 |
| 2U32014 | RU32 | 3/8 | 3/8 NPT | 0.669 | 17 | 9 | 55 | 27.1 | 20 | 16 |
| 2U32015 | RU32 | 3/8 | 1/2 NPT | 0.866 | 22 | 11 | 55 | 30 | 24.5 | 16 |
| 2U32017 | RU32 | 1/2 | 3/8 NPT | 0.67 | 17 | 9 | 60.4 | 28.2 | 20 | 20 |
| 2U32018 | RU32 | 1/2 | 1/2 NPT | 0.866 | 22 | 11 | 60.4 | 30.5 | 24.5 | 20 |

MALE ROD, SINGLE SWIVEL RING (RU54)

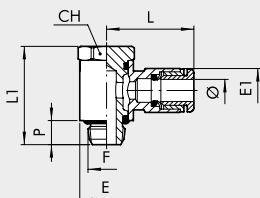

| Code | Ref. | Ø | F | Ch | | P | L | LI | E | EI |
|---------|------|------|-----------|-------|----|------|------|------|-----|------|
| | | | | Inc | mm | | | | | |
| 2U54001 | RU54 | 5/32 | 10-32 UNF | 0.354 | 9 | 4.5 | 20.2 | 18.7 | 9.5 | 9.5 |
| 2U54002 | RU54 | 5/32 | 1/8 NPT | 0.512 | 13 | 6.2 | 21.3 | 25.3 | 14 | 9.5 |
| 2U54007 | RU54 | 1/4 | 10-32 UNF | 0.354 | 9 | 4.5 | 23.5 | 18.7 | 9.5 | 11.8 |
| 2U54008 | RU54 | 1/4 | 1/8 NPT | 0.512 | 13 | 6.2 | 23 | 25.3 | 14 | 11.8 |
| 2U54009 | RU54 | 1/4 | 1/4 NPT | 5/8 | 16 | 8 | 24.5 | 29.2 | 18 | 11.8 |
| 2U54010 | RU54 | 5/16 | 1/8 NPT | 0.512 | 13 | 6.2 | 24.8 | 25.3 | 14 | 13.8 |
| 2U54011 | RU54 | 5/16 | 1/4 NPT | 5/8 | 16 | 8 | 26.5 | 29.2 | 18 | 13.8 |
| 2U54012 | RU54 | 5/16 | 3/8 NPT | 0.787 | 20 | 9 | 28.5 | 35.4 | 21 | 13.8 |
| 2U54013 | RU54 | 3/8 | 1/4 NPT | 5/8 | 16 | 8 | 31.7 | 29.2 | 18 | 16 |
| 2U54014 | RU54 | 3/8 | 3/8 NPT | 0.787 | 20 | 9 | 33.1 | 35.4 | 21 | 16 |
| 2U54016 | RU54 | 1/2 | 3/8 NPT | 0.787 | 20 | 10 | 36.6 | 35.4 | 21 | 20.2 |
| 2U54017 | RU54 | 1/2 | 1/2 NPT | 0.984 | 25 | 12.5 | 38.1 | 40 | 26 | 20.2 |

BRASS PUSH-IN FITTINGS FOR INCH TUBES AND UNF or NPT THREAD

FITTINGS

UNF
NPT

MALE ROD, DUAL SWIVEL RING (RU55)

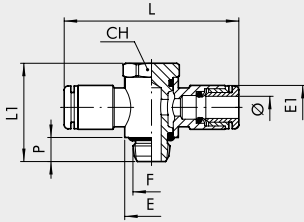

| Code | Ref. | Ø | F | Ch | | P | L | L1 | E | E1 |
|---------|------|------|-----------|-------|----|------|------|------|-----|------|
| | | | | Inc | mm | | | | | |
| 2U55001 | RU55 | 5/32 | 10-32 UNF | 0.354 | 9 | 4.5 | 40.4 | 18.7 | 9.5 | 9.5 |
| 2U55002 | RU55 | 5/32 | 1/8 NPT | 0.512 | 13 | 6.2 | 42.6 | 25.3 | 14 | 9.5 |
| 2U55007 | RU55 | 1/4 | 10-32 UNF | 0.354 | 9 | 4.5 | 47 | 18.7 | 9.5 | 11.8 |
| 2U55008 | RU55 | 1/4 | 1/8 NPT | 0.512 | 13 | 6.2 | 46 | 25.3 | 14 | 11.8 |
| 2U55009 | RU55 | 1/4 | 1/4 NPT | 5/64 | 16 | 8 | 49 | 29.2 | 18 | 11.8 |
| 2U55010 | RU55 | 5/16 | 1/8 NPT | 0.512 | 13 | 6.2 | 49.6 | 25.3 | 14 | 13.8 |
| 2U55011 | RU55 | 5/16 | 1/4 NPT | 5/64 | 16 | 8 | 53 | 29.2 | 18 | 13.8 |
| 2U55012 | RU55 | 5/16 | 3/8 NPT | 0.787 | 20 | 9 | 57 | 35.4 | 21 | 13.8 |
| 2U55013 | RU55 | 3/8 | 1/4 NPT | 5/64 | 16 | 8 | 63.4 | 29.2 | 18 | 16 |
| 2U55014 | RU55 | 3/8 | 3/8 NPT | 0.787 | 20 | 9 | 66.2 | 35.4 | 21 | 16 |
| 2U55016 | RU55 | 1/2 | 3/8 NPT | 0.787 | 20 | 10 | 73.2 | 35.4 | 21 | 20.2 |
| 2U55017 | RU55 | 1/2 | 1/2 NPT | 0.984 | 25 | 12.5 | 76.2 | 40 | 26 | 20.2 |

DUAL ROD, MALE SINGLE SWIVEL RINGS (RU56)

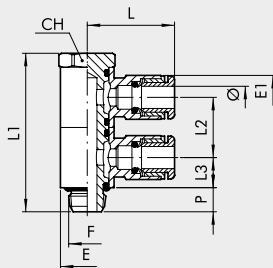

| Code | Ref. | Ø | F | Ch | | P | L | L1 | L2 | L3 | E | E1 |
|---------|------|------|-----------|-------|----|------|------|------|------|------|-----|------|
| | | | | Inc | mm | | | | | | | |
| 2U56001 | RU56 | 5/32 | 10-32 UNF | 0.354 | 9 | 4.5 | 20.2 | 30.2 | 11.5 | 5.8 | 9.5 | 9.5 |
| 2U56002 | RU56 | 5/32 | 1/8 NPT | 0.512 | 13 | 6.2 | 21.3 | 40.6 | 15.5 | 7.75 | 14 | 9.5 |
| 2U56007 | RU56 | 1/4 | 10-32 UNF | 0.354 | 9 | 4.5 | 23.5 | 30.2 | 11.5 | 5.8 | 9.5 | 11.8 |
| 2U56008 | RU56 | 1/4 | 1/8 NPT | 0.512 | 13 | 6.2 | 23 | 40.6 | 15.5 | 7.75 | 14 | 11.8 |
| 2U56009 | RU56 | 1/4 | 1/4 NP | 5/8 | 16 | 8 | 24.5 | 46.4 | 17.2 | 8.6 | 18 | 11.8 |
| 2U56010 | RU56 | 5/16 | 1/8 NPT | 0.512 | 13 | 6.2 | 24.8 | 40.6 | 15.5 | 7.75 | 14 | 13.8 |
| 2U56011 | RU56 | 5/16 | 1/4 NPT | 5/8 | 16 | 8 | 26.5 | 46.4 | 17.2 | 8.6 | 18 | 13.8 |
| 2U56012 | RU56 | 5/16 | 3/8 NPT | 0.787 | 20 | 9 | 28.5 | 56.8 | 21.4 | 10.7 | 21 | 13.8 |
| 2U56013 | RU56 | 3/8 | 1/4 NPT | 5/8 | 16 | 8 | 31.7 | 46.4 | 17.2 | 8.6 | 18 | 16 |
| 2U56014 | RU56 | 3/8 | 3/8 NPT | 0.787 | 20 | 9 | 33.1 | 56.8 | 21.4 | 10.7 | 21 | 16 |
| 2U56016 | RU56 | 1/2 | 3/8 NPT | 0.787 | 20 | 10 | 36.6 | 56.8 | 21.4 | 10.7 | 21 | 20.2 |
| 2U56017 | RU56 | 1/2 | 1/2 NPT | 0.984 | 25 | 12.5 | 38.1 | 64 | 24 | 12 | 26 | 20.2 |

DUAL ROD, MALE DUAL SWIVEL RINGS (RU57)

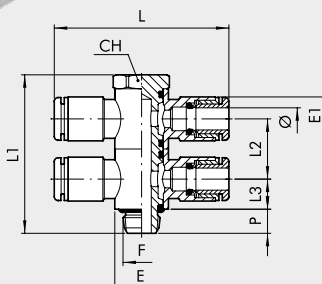

| Code | Ref. | Ø | F | Ch | | P | L | L1 | L2 | L3 | E | E1 |
|---------|------|------|-----------|-------|----|------|------|------|------|------|-----|------|
| | | | | Inc | mm | | | | | | | |
| 2U57001 | RU57 | 5/32 | 10-32 UNF | 0.354 | 9 | 4.5 | 40.4 | 30.2 | 11.5 | 5.8 | 9.5 | 9.5 |
| 2U57002 | RU57 | 5/32 | 1/8 NPT | 0.512 | 13 | 6.2 | 42.6 | 40.6 | 15.5 | 7.75 | 14 | 9.5 |
| 2U57007 | RU57 | 1/4 | 10-32 UNF | 0.354 | 9 | 4.5 | 47 | 30.2 | 11.5 | 5.8 | 9.5 | 11.8 |
| 2U57008 | RU57 | 1/4 | 1/8 NPT | 0.512 | 13 | 6.2 | 46 | 40.6 | 15.5 | 7.75 | 14 | 11.8 |
| 2U57009 | RU57 | 1/4 | 1/4 NPT | 5/8 | 16 | 8 | 49 | 46.4 | 17.2 | 8.6 | 18 | 11.8 |
| 2U57010 | RU57 | 5/16 | 1/8 NPT | 0.512 | 13 | 6.2 | 49.6 | 40.6 | 15.5 | 7.75 | 14 | 13.8 |
| 2U57011 | RU57 | 5/16 | 1/4 NPT | 5/8 | 16 | 8 | 53 | 46.4 | 17.2 | 8.6 | 18 | 13.8 |
| 2U57012 | RU57 | 5/16 | 3/8 NPT | 0.787 | 20 | 9 | 57 | 56.8 | 21.4 | 10.7 | 21 | 13.8 |
| 2U57013 | RU57 | 3/8 | 1/4 NPT | 5/8 | 16 | 8 | 63.4 | 46.4 | 17.2 | 8.6 | 18 | 16 |
| 2U57014 | RU57 | 3/8 | 3/8 NPT | 0.787 | 20 | 9 | 66.2 | 56.8 | 21.4 | 10.7 | 21 | 16 |
| 2U57016 | RU57 | 1/2 | 3/8 NPT | 0.787 | 20 | 10 | 73.2 | 56.8 | 21.4 | 10.7 | 21 | 20.2 |
| 2U57017 | RU57 | 1/2 | 1/2 NPT | 0.984 | 25 | 12.5 | 76.2 | 64 | 24 | 12 | 26 | 20.2 |

BRASS PUSH-IN FITTINGS FOR INCH TUBES AND UNF or NPT THREAD

FITTINGS



ADAPTORS AND PLUGS FOR G (BSPP) AND NPT THREAD

AU5/G - NPT FEMALE G (BSPP) MALE ADAPTORS

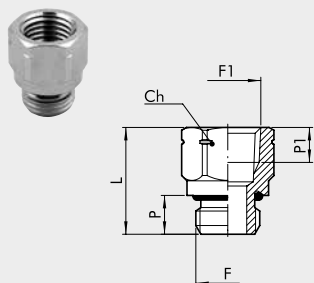

| Code | Ref. | F | F1 | Ch | | P | P1 | L |
|----------|-------|-------|-----------|-------|----|----|-----|------|
| | | | | Inc | mm | | | |
| 2105100U | AU5/G | M5 | 10-32 UNF | 5/16 | 8 | 4 | 4.5 | 11.8 |
| 2105101U | AU5/G | G 1/8 | 1/8 NPT | 0.551 | 14 | 6 | 7 | 18.5 |
| 2105103U | AU5/G | G 1/4 | 1/4 NPT | 0.669 | 17 | 8 | 7 | 22 |
| 2105105U | AU5/G | G 3/8 | 3/8 NPT | 0.866 | 22 | 9 | 9.5 | 26.2 |
| 2105107U | AU5/G | G 1/2 | 1/2 NPT | 0.984 | 25 | 11 | 9.5 | 29.2 |

AU5/N - NPT MALE G (BSPP) FEMALE ADAPTORS

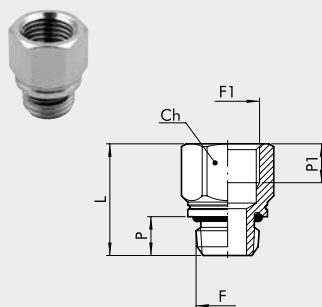

| Code | Ref. | F | F1 | Ch | | P | P1 | L |
|----------|-------|-----------|-------|-------|----|----|-----|------|
| | | | | Inc | mm | | | |
| 2105200U | AU5/N | 10-32 UNF | M5 | 5/16 | 8 | 4 | 4.5 | 11.8 |
| 2105201U | AU5/N | 1/8 NPT | G 1/8 | 0.551 | 14 | 6 | 6.7 | 18.5 |
| 2105203U | AU5/N | 1/4 NPT | G 1/4 | 0.669 | 17 | 8 | 8 | 23 |
| 2105205U | AU5/N | 3/8 NPT | G 3/8 | 0.866 | 22 | 9 | 10 | 26.7 |
| 2105207U | AU5/N | 1/2 NPT | G 1/2 | 0.984 | 25 | 11 | 11 | 31.2 |

AU7 - PLUG MALE NPT

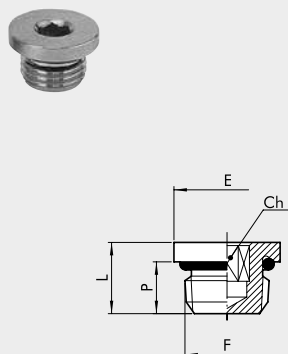

| Code | Ref. | F | Inc | Ch | | | E |
|----------|------|-----------|-------|----|----|------|------|
| | | | | mm | P | L | |
| 2107000U | AU7 | 10-32 UNF | 0.079 | 2 | 4 | 6.5 | 8 |
| 2107001U | AU7 | 1/8 NPT | 0.118 | 3 | 6 | 8.5 | 13 |
| 2107002U | AU7 | 1/4 NPT | 0.236 | 6 | 8 | 11 | 16.4 |
| 2107003U | AU7 | 3/8 NPT | 5/16 | 8 | 9 | 12.5 | 20 |
| 2107004U | AU7 | 1/2 NPT | 0.394 | 10 | 11 | 14.5 | 24.5 |

IDENTIFICATION MARK FOR AU5

An identification mark near the NPT thread is used to distinguish it from the G (BSPP) thread.

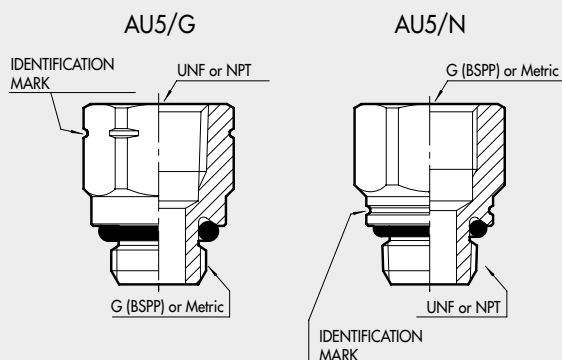

EXAMPLE

TRANSFORMATION FROM M5 TO 10-32 UNF

- ① REGTRONIC M5 with display code **5520500**
REGTRONIC M5 remote control code **5520502**
- ② AU5/G M5 10/32 UNF code **2105100U**

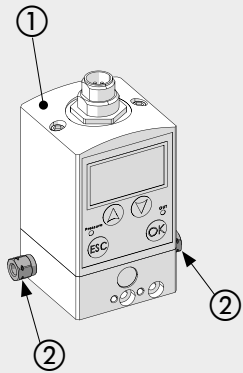

TRANSFORMATION FROM 1/4 G (BSPP) TO 1/4 NPT

- ① REGTRONIC G1/4 with display code **5522500**
REGTRONIC G1/4 remote control code **5522502**
- ② REG. GS G1/4 02 code **5512200**
REG. GS G1/4 04 code **5512300**
REG. GS G1/4 08 code **5512400**
- ③ AU5/G G1/4 - 1/4 NPT code **2105103U**

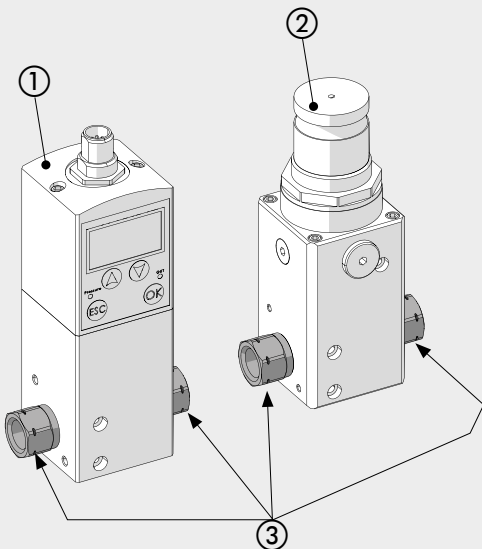

TRANSFORMATION FROM 1/8 G (BSPP) TO 1/8 NPT

- ① REGTRONIC G1/8 with display code **5521500**
REGTRONIC G1/8 remote control code **5521502**
- ② REG. GS G1/8 02 code **5511200**
REG. GS G1/8 04 code **5511300**
REG. GS G1/8 08 code **5511400**
- ③ AU5/G G1/8 - 1/8 NPT code **2105101U**

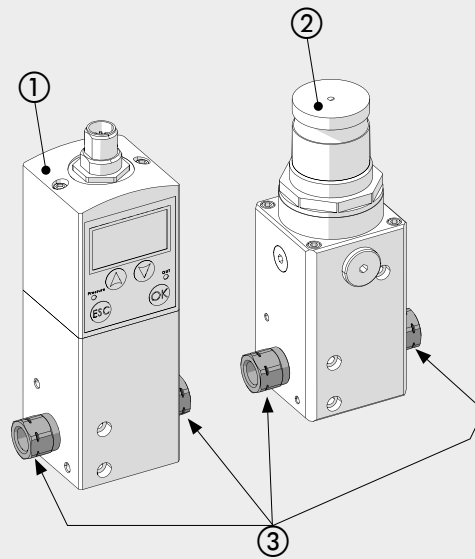

- ① Digital pressure switch series 600 code **9000600**
- ② AU5/G G1/8 - 1/8 NPT code **2105101U**

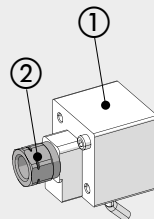

- ① Digital pressure switch series 640 code **9000640**
- ② AU5/N 1/8 NPT - G1/8 code **2105201U**

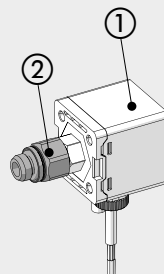



TECHNOPOLYMER PUSH-IN FITTINGS FOR mm TUBES AND G (BSP) or METRIC THREAD

STRAIGHT, INTERMEDIATE, TECHNOPOLYMER (R19)

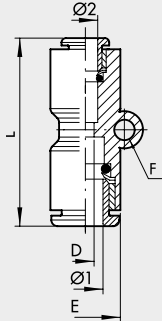

| Code | Ref. | Ø1 | Ø2 | E | L | D | F |
|---------|------|----|----|------|------|------|-----|
| 2019001 | RL19 | 4 | 4 | 9.2 | 30.4 | 3 | 3.3 |
| 2019002 | R19 | 5 | 5 | 14 | 33.5 | 4 | - |
| 2019003 | RL19 | 6 | 6 | 11.3 | 33 | 5 | 3.3 |
| 2019004 | RL19 | 8 | 8 | 13.8 | 36.2 | 6.5 | 3.3 |
| 2019005 | RL19 | 10 | 10 | 16 | 38 | 8.5 | 3.3 |
| 2019006 | RL19 | 12 | 12 | 19.5 | 40 | 10.5 | 3.3 |
| 2019303 | RL19 | 6 | 4 | 11.3 | 32.7 | 3 | 3.3 |
| 2019304 | RL19 | 8 | 6 | 13.8 | 36.1 | 5 | 3.3 |
| 2019305 | RL19 | 10 | 8 | 16 | 37.8 | 6.5 | 3.3 |
| 2019306 | RL19 | 12 | 10 | 19.5 | 40 | 8.5 | 3.3 |

MALE ROD, SINGLE ROTARY RING, TECHNOPOLYMER (R20)

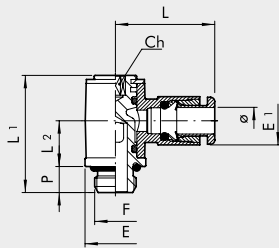

| Code | Ref. | Ø | F | Ch | P | L | L1 | L2 | E | E1 |
|---------|------|----|-----|----|----|------|------|------|-----|------|
| 2020001 | RL20 | 4 | M5 | 2 | 4 | 18.7 | 18.4 | 9.1 | 8 | 9.2 |
| 2020002 | RL20 | 4 | 1/8 | 3 | 6 | 21 | 24.9 | 12.3 | 14 | 9.2 |
| 2020003 | R20 | 5 | M5 | 2 | 4 | 21.5 | 18.8 | 8.5 | 9.9 | 13.5 |
| 2020004 | R20 | 5 | 1/8 | 3 | 6 | 23 | 27 | 10.5 | 14 | 13.5 |
| 2020016 | RL20 | 6 | M5 | 2 | 4 | 20.8 | 18.4 | 9.1 | 8 | 11.3 |
| 2020005 | RL20 | 6 | 1/8 | 3 | 6 | 22.3 | 24.9 | 12.3 | 14 | 11.3 |
| 2020007 | RL20 | 6 | 1/4 | 4 | 8 | 24.3 | 29.4 | 14.3 | 18 | 11.3 |
| 2020006 | RL20 | 8 | 1/8 | 3 | 6 | 25.6 | 24.9 | 12.3 | 14 | 13.8 |
| 2020008 | RL20 | 8 | 1/4 | 4 | 8 | 27.2 | 29.4 | 14.3 | 18 | 13.8 |
| 2020009 | RL20 | 10 | 1/4 | 4 | 8 | 28.6 | 29.4 | 14.3 | 18 | 16 |
| 2L20017 | RL20 | 10 | 3/8 | 5 | 9 | 30.5 | 35.6 | 15.3 | 22 | 16 |
| 2020010 | RL20 | 12 | 1/4 | 4 | 8 | 31 | 29.4 | 14.3 | 18 | 19.5 |
| 2020011 | RL20 | 12 | 3/8 | 5 | 9 | 32.4 | 35.6 | 17.5 | 22 | 19.5 |
| 2020012 | RL20 | 12 | 1/2 | 8 | 11 | 34 | 40.8 | 19.2 | 26 | 19.5 |

MALE ROD, DUAL ROTARY RING, TECHNOPOLYMER (R20/A)

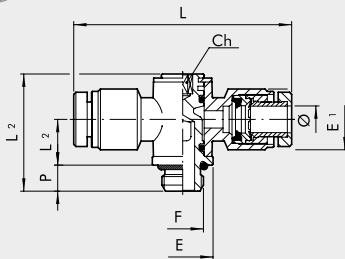

| Code | Ref. | Ø | F | Ch | P | L | L1 | L2 | E | E1 |
|---------|-------|----|-----|----|----|----|------|------|-----|------|
| 2020A01 | R20/A | 4 | M5 | 2 | 4 | 40 | 16.8 | 6.5 | 9.9 | 10.9 |
| 2020A02 | R20/A | 4 | 1/8 | 3 | 6 | 45 | 27 | 10.5 | 14 | 12.5 |
| 2020A03 | R20/A | 5 | M5 | 2 | 4 | 43 | 18.8 | 8.5 | 9.9 | 13.5 |
| 2020A04 | R20/A | 5 | 1/8 | 3 | 6 | 46 | 27 | 10.5 | 14 | 13.5 |
| 2020A05 | R20/A | 6 | 1/8 | 3 | 6 | 45 | 27 | 10.5 | 14 | 15 |
| 2020A07 | R20/A | 6 | 1/4 | 4 | 8 | 48 | 31.5 | 11.5 | 18 | 15 |
| 2020A06 | R20/A | 8 | 1/8 | 3 | 6 | 51 | 27 | 10.5 | 14 | 16.3 |
| 2020A08 | R20/A | 8 | 1/4 | 4 | 8 | 54 | 31.5 | 11.5 | 18 | 16.3 |
| 2020A09 | R20/A | 10 | 1/4 | 4 | 8 | 64 | 31.5 | 11.5 | 18 | 18.5 |
| 2020A10 | R20/A | 12 | 1/4 | 4 | 8 | 64 | 31.5 | 11.5 | 18 | 21 |
| 2020A11 | R20/A | 12 | 3/8 | 5 | 9 | 68 | 36 | 13.5 | 22 | 21 |
| 2020A12 | R20/A | 12 | 1/2 | 8 | 11 | 72 | 42 | 16.2 | 26 | 21 |

ELBOW, INTERMEDIATE, TECHNOPOLYMER (R21)

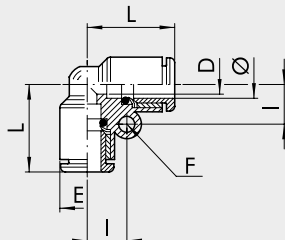

| Code | Ref. | Ø | L | D | E | I | F |
|---------|------|----|------|------|------|------|-----|
| 2L21001 | RL21 | 4 | 16.7 | 2.5 | 9.2 | 7.2 | 3.3 |
| 2021002 | R21 | 5 | 20 | 3.5 | 13.5 | - | - |
| 2L21003 | RL21 | 6 | 19 | 4.2 | 11.3 | 8.2 | 3.3 |
| 2L21004 | RL21 | 8 | 21.4 | 6.2 | 13.8 | 9.6 | 3.3 |
| 2021005 | RL21 | 10 | 24 | 8.5 | 16 | 10.9 | 3.3 |
| 2021006 | RL21 | 12 | 25.8 | 10.5 | 19.5 | 12.5 | 3.3 |

TECHNOPOLYMER PUSH-IN FITTINGS FOR mm TUBES AND G (BSP) or METRIC THREAD

FITTINGS



INTERMEDIATE TEE, TECHNOPOLYMER (R22)

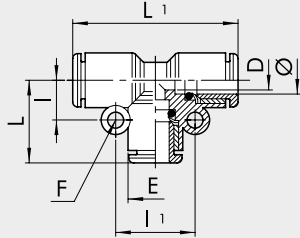

| Code | Ref. | Ø | L | L1 | D | E | I | I1 | F |
|---------|------|----|------|------|------|------|------|------|-----|
| 2122001 | RL22 | 4 | 16.7 | 33.4 | 2.5 | 9.2 | 7.2 | 14.4 | 3.3 |
| 2022002 | R22 | 5 | 20 | 40 | 3.5 | 13.5 | - | - | - |
| 2122003 | RL22 | 6 | 19 | 38 | 4.2 | 11.3 | 8.2 | 16.4 | 3.3 |
| 2122004 | RL22 | 8 | 21.4 | 42.8 | 6.2 | 13.8 | 9.6 | 19.2 | 3.3 |
| 2022005 | RL22 | 10 | 24 | 48 | 8.5 | 16 | 10.9 | 21.8 | 3.3 |
| 2022006 | RL22 | 12 | 25.8 | 51.6 | 10.5 | 19.5 | 12.5 | 25 | 3.3 |

WYE (R23)

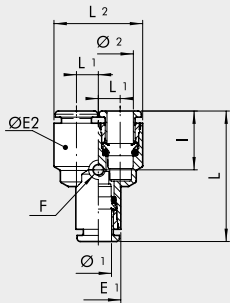

| Code | Ref. | Ø1 | Ø2 | L | L1 | E1 | ØE2 | I | F | L2 |
|---------|------|----|----|------|-----|------|------|------|-----|------|
| 2023001 | RL23 | 4 | 4 | 32.9 | 5 | 9.2 | 9.2 | 14.8 | 3.3 | 19.2 |
| 2023002 | R23 | 5 | 5 | 35.5 | 6.5 | 13.5 | 13.5 | - | - | 26.5 |
| 2023003 | RL23 | 6 | 6 | 35.5 | 5.8 | 11.3 | 11.3 | 15 | 3.3 | 22.8 |
| 2023004 | RL23 | 8 | 8 | 39.5 | 7.2 | 13.8 | 13.8 | 15.8 | 3.3 | 28.2 |
| 2123005 | RL23 | 10 | 10 | 43.1 | 8.3 | 16 | 16 | 17.4 | 3.3 | 32.6 |
| 2123006 | RL23 | 12 | 12 | 48 | 10 | 19.5 | 19.5 | 18 | 3.3 | 39.5 |
| 2123301 | RL23 | 6 | 4 | 34.2 | 5 | 11.3 | 9.2 | 14.8 | 3.3 | 19.2 |
| 2123303 | RL23 | 8 | 6 | 37.8 | 5.8 | 13.8 | 11.3 | 15 | 3.3 | 22.8 |
| 2123306 | RL23 | 10 | 8 | 40.4 | 7.2 | 16 | 13.8 | 15.8 | 3.3 | 28.2 |
| 2123309 | RL23 | 12 | 10 | 44.2 | 8.3 | 19.5 | 16 | 17.4 | 3.3 | 32.6 |

Y TECHNOPOLYMER, THREADED INPUT (R23/M)

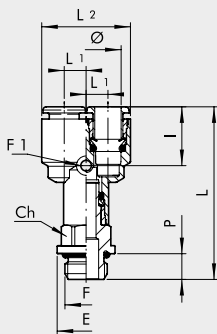

| Code | Ref. | Ø | F | L | L1 | L2 | I | Ch | P | E | F1 |
|---------|--------|----|-----|------|------|------|------|----|----|-----|-----|
| 2123401 | RL23/M | 4 | M5 | 38.7 | 5 | 19.2 | 14.8 | 9 | 4 | 9.9 | 3.3 |
| 2123402 | RL23/M | 4 | 1/8 | 42.6 | 5 | 19.2 | 14.8 | 12 | 6 | 14 | 3.3 |
| 2123403 | RL23/M | 4 | 1/4 | 46.6 | 5 | 19.2 | 14.8 | 14 | 8 | 18 | 3.3 |
| 2123406 | RL23/M | 6 | 1/8 | 44.9 | 5.75 | 22.8 | 15 | 12 | 6 | 14 | 3.3 |
| 2123407 | RL23/M | 6 | 1/4 | 47.9 | 5.75 | 22.8 | 15 | 14 | 8 | 18 | 3.3 |
| 2123409 | RL23/M | 8 | 1/8 | 48.4 | 7.2 | 28.2 | 15.8 | 14 | 6 | 15 | 3.3 |
| 2123410 | RL23/M | 8 | 1/4 | 52.8 | 7.2 | 28.2 | 15.8 | 14 | 8 | 18 | 3.3 |
| 2123412 | RL23/M | 8 | 3/8 | 54.4 | 7.2 | 28.2 | 15.8 | 17 | 9 | 22 | 3.3 |
| 2123413 | RL23/M | 10 | 1/4 | 53.8 | 8.3 | 32.6 | 17.4 | 16 | 8 | 18 | 3.3 |
| 2123415 | RL23/M | 10 | 3/8 | 56 | 8.3 | 32.6 | 17.4 | 17 | 9 | 20 | 3.3 |
| 2123419 | RL23/M | 12 | 3/8 | 62 | 10 | 39.5 | 18 | 19 | 9 | 22 | 3.3 |
| 2123420 | RL23/M | 12 | 1/2 | 62.3 | 10 | 39.5 | 18 | 22 | 11 | 26 | 3.3 |

Y BRANCH WITH ADAPTER, TECHNOPOLYMER (R24)

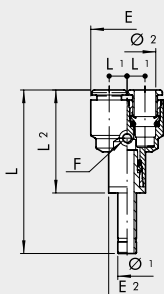

| Code | Ref. | Ø1 | Ø2 | L | L1 | L2 | E1 | E2 | I | F |
|---------|------|----|----|------|------|------|------|------|------|-----|
| 2024001 | RL24 | 4 | 4 | 46.9 | 5 | 29.7 | 9.2 | 9.2 | 14.8 | 3.3 |
| 2024003 | RL24 | 6 | 6 | 49.7 | 5.75 | 32 | 11.3 | 11.3 | 15 | 3.3 |
| 2124004 | RL24 | 8 | 8 | 55.1 | 7.2 | 35.9 | 13.8 | 13.8 | 15.8 | 3.3 |
| 2124005 | RL24 | 10 | 10 | 63.1 | 8.3 | 39.2 | 16 | 16 | 17.4 | 3.3 |
| 2124006 | RL24 | 12 | 12 | 70.5 | 10 | 44 | 19.5 | 19.5 | 18 | 3.3 |
| 2124301 | RL24 | 6 | 4 | 48.4 | 5 | 30.7 | 9.2 | 11.3 | 14.8 | 3.3 |
| 2124303 | RL24 | 8 | 6 | 53.4 | 5.75 | 34.2 | 11.3 | 13.8 | 15 | 3.3 |
| 2124306 | RL24 | 10 | 8 | 60.4 | 7.2 | 36.6 | 13.8 | 16 | 15.8 | 3.3 |
| 2124309 | RL24 | 12 | 10 | 66.7 | 8.3 | 40.2 | 16 | 19.5 | 17.4 | 3.3 |



TECHNOPOLYMER PARALLEL Y, THREADED INPUT (R25)

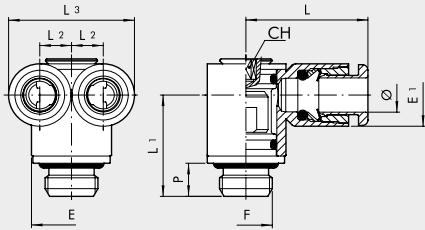

| Code | Ref. | Ø | F | L | L1 | L2 | L3 | E | E1 | CH | P |
|---------|------|---|-----|------|------|------|------|------|------|----|---|
| 2L25001 | RL25 | 4 | M5 | 17.7 | 13.1 | 5 | 19.2 | 8 | 9.2 | 2 | 4 |
| 2L25002 | RL25 | 4 | M7 | 17.7 | 14.6 | 5 | 19.2 | 9.8 | 9.2 | 3 | 5 |
| 2L25003 | RL25 | 4 | 1/8 | 17.7 | 16.5 | 5 | 19.2 | 13 | 9.2 | 3 | 6 |
| 2L25004 | RL25 | 6 | 1/8 | 23 | 18.3 | 5.75 | 22.8 | 14 | 11.3 | 3 | 6 |
| 2L25005 | RL25 | 6 | 1/4 | 23 | 21.2 | 5.75 | 22.8 | 16.4 | 11.3 | 4 | 8 |
| 2L25008 | RL25 | 8 | 1/4 | 25.8 | 22.2 | 7.2 | 28.2 | 18 | 13.8 | 4 | 8 |
| 2L25009 | RL25 | 8 | 3/8 | 25.8 | 23.8 | 7.2 | 28.2 | 20 | 13.8 | 5 | 9 |

SINGLE RING, TECHNOPOLYMER (R28)

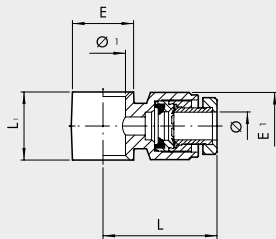

| Code | Ref. | Ø | Ø 1 | L | L1 | E | E1 |
|---------|------|----|-----|------|----|------|------|
| 2012102 | R28 | 4 | 1/8 | 22.5 | 17 | 15 | 12.5 |
| 2012104 | R28 | 5 | 1/8 | 23 | 17 | 15 | 13.5 |
| 2012106 | R28 | 6 | 1/8 | 22.5 | 17 | 15 | 15 |
| 2012107 | R28 | 6 | 1/4 | 24 | 19 | 18 | 15 |
| 2012108 | R28 | 8 | 1/8 | 25.5 | 17 | 15 | 16.5 |
| 2012109 | R28 | 8 | 1/4 | 27 | 19 | 18 | 16.5 |
| 2012110 | R28 | 8 | 3/8 | 29 | 22 | 21.5 | 16.5 |
| 2012111 | R28 | 10 | 1/4 | 32 | 19 | 18 | 18.5 |
| 2012112 | R28 | 10 | 3/8 | 32 | 22 | 21.5 | 18.5 |
| 2012113 | R28 | 12 | 1/4 | 32 | 19 | 18 | 21 |
| 2012114 | R28 | 12 | 3/8 | 34 | 22 | 21.5 | 21 |
| 2012115 | R28 | 12 | 1/2 | 36 | 24 | 26 | 21 |

For the rods series D, see page D2.15

DUAL RING, TECHNOPOLYMER (R29)

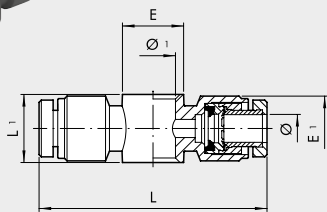

| Code | Ref. | Ø | Ø 1 | L | L1 | E | E1 |
|---------|------|----|-----|----|----|------|------|
| 2013102 | R29 | 4 | 1/8 | 45 | 17 | 15 | 12.5 |
| 2013104 | R29 | 5 | 1/8 | 46 | 17 | 15 | 13.5 |
| 2013106 | R29 | 6 | 1/8 | 45 | 17 | 15 | 15 |
| 2013107 | R29 | 6 | 1/4 | 48 | 19 | 18 | 15 |
| 2013108 | R29 | 8 | 1/8 | 51 | 17 | 15 | 16.5 |
| 2013109 | R29 | 8 | 1/4 | 54 | 19 | 18 | 16.5 |
| 2013110 | R29 | 8 | 3/8 | 58 | 22 | 21.5 | 16.5 |
| 2013111 | R29 | 10 | 1/4 | 64 | 19 | 18 | 18.5 |
| 2013112 | R29 | 10 | 3/8 | 64 | 22 | 21.5 | 18.5 |
| 2013113 | R29 | 12 | 1/4 | 64 | 19 | 18 | 21 |
| 2013114 | R29 | 12 | 3/8 | 68 | 22 | 21.5 | 21 |
| 2013115 | R29 | 12 | 1/2 | 72 | 24 | 26 | 21 |

For the rods series D, see page D2.15

ROTARY ELBOW, MALE, TECHNOPOLYMER (R34)

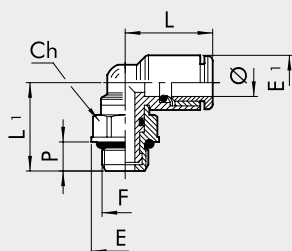

| Code | Ref. | Ø | F | Ch | P | L | L1 | E | E1 |
|---------|------|----|-----|----|----|------|------|-----|------|
| 2L34001 | RL34 | 4 | M5 | 8 | 4 | 16.4 | 15.2 | 9 | 9.2 |
| 2L34020 | RL34 | 4 | M7 | 8 | 5 | 16.4 | 16.2 | 9.8 | 9.2 |
| 2L34002 | RL34 | 4 | 1/8 | 12 | 6 | 16.4 | 17.2 | 14 | 9.2 |
| 2L34003 | RL34 | 4 | 1/4 | 14 | 8 | 16.4 | 20.1 | 18 | 9.2 |
| 2L34006 | RL34 | 6 | M5 | 8 | 4 | 18 | 16.3 | 9 | 11.3 |
| 2L34021 | RL34 | 6 | M7 | 9 | 5 | 19 | 17.5 | 9.9 | 11.3 |
| 2L34007 | RL34 | 6 | 1/8 | 12 | 6 | 19 | 18.3 | 14 | 11.3 |
| 2L34008 | RL34 | 6 | 1/4 | 14 | 8 | 19 | 21.2 | 18 | 11.3 |
| 2L34009 | RL34 | 8 | 1/8 | 12 | 6 | 20.2 | 19.5 | 14 | 13.8 |
| 2L34010 | RL34 | 8 | 1/4 | 14 | 8 | 20.2 | 22.4 | 18 | 13.8 |
| 2L34011 | RL34 | 8 | 3/8 | 17 | 9 | 20.2 | 24.4 | 22 | 13.8 |
| 2L34013 | RL34 | 10 | 1/4 | 14 | 8 | 23.3 | 23.5 | 18 | 16 |
| 2L34014 | RL34 | 10 | 3/8 | 17 | 9 | 23.3 | 25.6 | 22 | 16 |
| 2L34016 | RL34 | 12 | 3/8 | 17 | 9 | 25.2 | 27.3 | 22 | 19.5 |
| 2L34017 | RL34 | 12 | 1/2 | 19 | 11 | 25.2 | 30.3 | 26 | 19.5 |

TECHNOPOLYMER PUSH-IN FITTINGS FOR mm TUBES AND G (BSP) or METRIC THREAD

FITTINGS



ELBOW, FEMALE, ROTARY, TECHNOPOLYMER (R34/F)

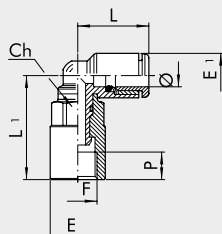

| Code | Ref. | Ø | F | Ch | E | E1 | L | L1 | P |
|---------|-----------|-----|----|------|------|------|------|----|---|
| 2L34F01 | RL34/F 4 | M5 | 8 | 9 | 9.2 | 16.4 | 15.3 | 4 | |
| 2L34F05 | RL34/F 4 | 1/8 | 12 | 14 | 9.2 | 16.4 | 20.9 | 7 | |
| 2L34F06 | RL34/F 6 | M5 | 8 | 9 | 11.3 | 18 | 16.4 | 4 | |
| 2L34F07 | RL34/F 6 | 1/8 | 12 | 14 | 11.3 | 19 | 26.5 | 7 | |
| 2L34F08 | RL34/F 6 | 1/4 | 14 | 17 | 11.3 | 19 | 28.2 | 8 | |
| 2L34F09 | RL34/F 8 | 1/8 | 12 | 14 | 13.8 | 20.2 | 27.7 | 7 | |
| 2L34F10 | RL34/F 8 | 1/4 | 14 | 17 | 13.8 | 20.2 | 29.4 | 8 | |
| 2L34F13 | RL34/F 10 | 1/4 | 14 | 17 | 16 | 23.3 | 33 | 8 | |
| 2L34F14 | RL34/F 10 | 3/8 | 17 | 21 | 16 | 23.3 | 38 | 10 | |
| 2L34F16 | RL34/F 12 | 3/8 | 17 | 21 | 19.5 | 25.2 | 40.3 | 10 | |
| 2L34F17 | RL34/F 12 | 1/2 | 19 | 23.8 | 19.5 | 25.2 | 42.8 | 11 | |

CENTRAL TEE, MALE, TECHNOPOLYMER (R35)

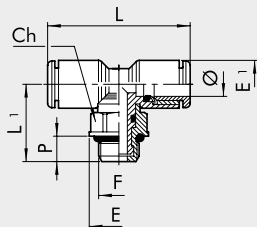

| Code | Ref. | Ø | F | Ch | P | L | L1 | E | E1 |
|---------|---------|-----|----|----|------|------|-----|------|----|
| 2L35001 | RL35 4 | M5 | 8 | 4 | 32.8 | 15.2 | 9 | 9.2 | |
| 2L35020 | RL35 4 | M7 | 8 | 5 | 32.8 | 16.2 | 9.8 | 9.2 | |
| 2L35002 | RL35 4 | 1/8 | 12 | 6 | 32.8 | 17.2 | 14 | 9.2 | |
| 2L35003 | RL35 4 | 1/4 | 14 | 8 | 32.8 | 20.1 | 18 | 9.2 | |
| 2L35006 | RL35 6 | M5 | 8 | 4 | 36 | 16.3 | 9 | 11.3 | |
| 2L35007 | RL35 6 | 1/8 | 12 | 6 | 38 | 18.3 | 14 | 11.3 | |
| 2L35008 | RL35 6 | 1/4 | 14 | 8 | 38 | 21.2 | 18 | 11.3 | |
| 2L35009 | RL35 8 | 1/8 | 12 | 6 | 40.4 | 19.5 | 14 | 13.8 | |
| 2L35010 | RL35 8 | 1/4 | 14 | 8 | 40.4 | 22.4 | 18 | 13.8 | |
| 2L35011 | RL35 8 | 3/8 | 17 | 9 | 40.4 | 24.4 | 22 | 13.8 | |
| 2L35013 | RL35 10 | 1/4 | 14 | 8 | 46.6 | 23.5 | 18 | 16 | |
| 2L35014 | RL35 10 | 3/8 | 17 | 9 | 46.6 | 25.6 | 22 | 16 | |
| 2L35016 | RL35 12 | 3/8 | 17 | 9 | 50.4 | 27.3 | 22 | 19.5 | |
| 2L35017 | RL35 12 | 1/2 | 19 | 11 | 50.4 | 30.3 | 26 | 19.5 | |

CENTRAL TEE, FEMALE, ROTARY, TECHNOPOLYMER (R35/F)

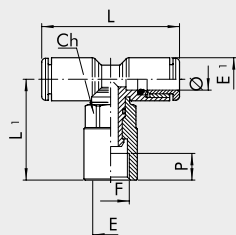

| Code | Ref. | Ø | F | Ch | E | E1 | L | L1 | P |
|---------|-----------|-----|----|------|------|------|------|----|---|
| 2L35F01 | RL35/F 4 | M5 | 8 | 9 | 9.2 | 32.8 | 15.3 | 4 | |
| 2L35F06 | RL35/F 6 | M5 | 8 | 9 | 11.3 | 36 | 16.4 | 4 | |
| 2L35F07 | RL35/F 6 | 1/8 | 12 | 14 | 11.3 | 38 | 26.5 | 7 | |
| 2L35F08 | RL35/F 6 | 1/4 | 14 | 17 | 11.3 | 38 | 28.2 | 8 | |
| 2L35F09 | RL35/F 8 | 1/8 | 12 | 14 | 13.8 | 40.4 | 27.7 | 7 | |
| 2L35F10 | RL35/F 8 | 1/4 | 14 | 17 | 13.8 | 40.4 | 29.4 | 8 | |
| 2L35F13 | RL35/F 10 | 1/4 | 14 | 17 | 16 | 46.6 | 33 | 8 | |
| 2L35F14 | RL35/F 10 | 3/8 | 17 | 21 | 16 | 46.6 | 38 | 10 | |
| 2L35F16 | RL35/F 12 | 3/8 | 17 | 21 | 19.5 | 50.4 | 40.3 | 10 | |
| 2L35F17 | RL35/F 12 | 1/2 | 19 | 23.8 | 19.5 | 50.4 | 42.8 | 11 | |

ROTARY ELBOW, MALE, EXTENDED, TECHNOPOLYMER (R36)

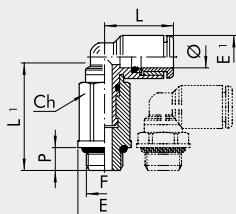

| Code | Ref. | Ø | F | Ch | P | L | L1 | E | E1 |
|---------|---------|-----|----|----|------|------|-----|------|----|
| 2L36001 | RL36 4 | M5 | 8 | 4 | 16.4 | 26.7 | 9 | 9.2 | |
| 2L36020 | RL36 4 | M7 | 8 | 5 | 16.4 | 27.7 | 9.8 | 9.2 | |
| 2L36002 | RL36 4 | 1/8 | 12 | 6 | 16.4 | 25.3 | 14 | 9.2 | |
| 2L36006 | RL36 6 | M5 | 8 | 4 | 18 | 27.8 | 9 | 11.3 | |
| 2L36021 | RL36 6 | M7 | 9 | 5 | 18 | 29.3 | 9.9 | 11.3 | |
| 2L36007 | RL36 6 | 1/8 | 12 | 6 | 19 | 30.9 | 14 | 11.3 | |
| 2L36008 | RL36 6 | 1/4 | 14 | 8 | 19 | 33.2 | 18 | 11.3 | |
| 2L36009 | RL36 8 | 1/8 | 12 | 6 | 20.2 | 32.1 | 14 | 13.8 | |
| 2L36010 | RL36 8 | 1/4 | 14 | 8 | 20.2 | 34.4 | 18 | 13.8 | |
| 2L36012 | RL36 10 | 1/4 | 14 | 8 | 23.3 | 38 | 18 | 16 | |



CENTRAL TEE, MALE, ROTARY, EXTENDED, TECHNOPOLYMER (R37)

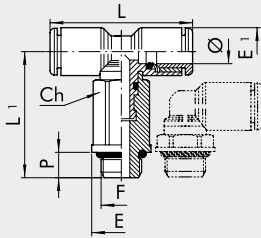

| Code | Ref. | Ø | F | Ch | P | L | L1 | E | E1 |
|---------|------|----|-----|----|---|------|------|-----|------|
| 2L37001 | RL37 | 4 | M5 | 8 | 4 | 32.8 | 26.7 | 9 | 9.2 |
| 2L37020 | RL37 | 4 | M7 | 8 | 5 | 32.8 | 27.5 | 9.8 | 9.2 |
| 2L37002 | RL37 | 4 | 1/8 | 12 | 6 | 32.8 | 25.3 | 14 | 9.2 |
| 2L37006 | RL37 | 6 | M5 | 8 | 4 | 36 | 27.8 | 9 | 11.3 |
| 2L37007 | RL37 | 6 | 1/8 | 12 | 6 | 38 | 30.9 | 14 | 11.3 |
| 2L37008 | RL37 | 6 | 1/4 | 14 | 8 | 38 | 33.2 | 18 | 11.3 |
| 2L37009 | RL37 | 8 | 1/8 | 12 | 6 | 40.4 | 32.1 | 14 | 13.8 |
| 2L37010 | RL37 | 8 | 1/4 | 14 | 8 | 40.4 | 34.4 | 18 | 13.8 |
| 2L37012 | RL37 | 10 | 1/4 | 14 | 8 | 46.6 | 38 | 18 | 16 |

DUAL Y BRANCH TECHNOPOLYMER (R42)

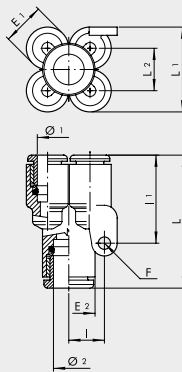

| Code | Ref. | Ø1 | Ø2 | E1 | E2 | L | L1 | L2 | I | I1 | F |
|---------|------|----|----|------|------|------|------|------|-----|------|-----|
| 2L42001 | RL42 | 4 | 4 | 9.2 | 9.2 | 28.8 | 17.9 | 8.7 | 8 | 21.3 | 3.3 |
| 2L42002 | RL42 | 4 | 6 | 9.2 | 11.3 | 31.3 | 17.9 | 8.7 | 8 | 21.3 | 3.3 |
| 2L42004 | RL42 | 6 | 6 | 11.3 | 11.3 | 33.4 | 22.6 | 11.3 | 9.5 | 25.6 | 3.3 |
| 2L42005 | RL42 | 6 | 8 | 11.3 | 14 | 34.8 | 22.6 | 11.3 | 9.5 | 25.6 | 3.3 |

DUAL Y BRANCH TECHNOPOLYMER, THREADED INPUT (R43)

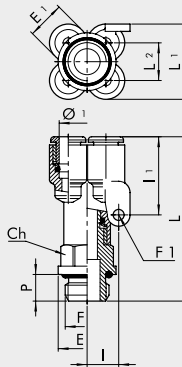

| Code | Ref. | Ø1 | F | E1 | E | Ch | P | L | L1 | L2 | I | I1 | F1 |
|---------|------|----|-----|------|----|----|---|------|------|------|-----|------|-----|
| 2L43001 | RL43 | 4 | M5 | 9.2 | 8 | 9 | 4 | 35.5 | 17.9 | 8.7 | 8 | 21.3 | 3.3 |
| 2L43002 | RL43 | 4 | 1/8 | 9.2 | 14 | 12 | 6 | 41.6 | 17.9 | 8.7 | 8 | 21.3 | 3.3 |
| 2L43003 | RL43 | 4 | 1/4 | 9.2 | 18 | 14 | 8 | 44.6 | 17.9 | 8.7 | 8 | 21.3 | 3.3 |
| 2L43008 | RL43 | 6 | 1/8 | 11.3 | 14 | 12 | 6 | 43.7 | 22.6 | 11.3 | 9.5 | 25.6 | 3.3 |
| 2L43009 | RL43 | 6 | 1/4 | 11.3 | 18 | 14 | 8 | 46.7 | 22.6 | 11.3 | 9.5 | 25.6 | 3.3 |

MULTIPLE MANIFOLD, TECHNOPOLYMER (R44)

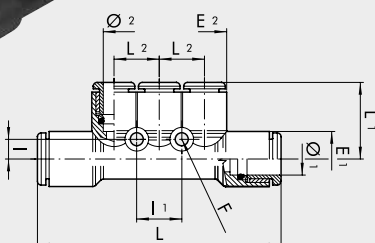

| Code | Ref. | Ø1 | Ø2 | E1 | E2 | L | L1 | L2 | I | I1 | F |
|---------|------|----|----|------|------|------|------|------|-----|------|-----|
| 2L44001 | RL44 | 6 | 4 | 11.3 | 9.2 | 53.2 | 17.2 | 9.4 | 4.3 | 9.4 | 3.3 |
| 2L44003 | RL44 | 8 | 6 | 14 | 11.3 | 61.4 | 19.6 | 11.5 | 5 | 11.5 | 3.3 |

TECHNOPOLYMER PUSH-IN FITTINGS FOR mm TUBES AND G (BSP) or METRIC THREAD

FITTINGS



MULTIPLE MANIFOLD, INPUT, THREADED, TECHNOPOLYMER (R45)

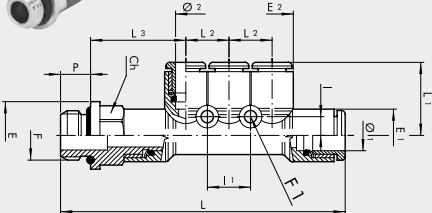

| Code | Ref. | F | Ø1 | Ø2 | E1 | E2 | E | Ch | P | L | L1 | L2 | L3 | I | I1 | F1 |
|---------|------|-----|----|----|------|------|----|----|---|------|------|------|------|-----|------|-----|
| 2L45001 | RL45 | 1/8 | 6 | 4 | 11.3 | 9.2 | 14 | 12 | 6 | 63.5 | 17.2 | 9.4 | 21.5 | 4.3 | 9.4 | 3.3 |
| 2L45002 | RL45 | 1/4 | 6 | 4 | 11.3 | 9.2 | 18 | 14 | 8 | 66.5 | 17.2 | 9.4 | 22.5 | 4.3 | 9.4 | 3.3 |
| 2L45007 | RL45 | 1/8 | 8 | 6 | 14 | 11.3 | 15 | 14 | 6 | 71.2 | 19.6 | 11.5 | 23 | 5 | 11.5 | 3.3 |
| 2L45008 | RL45 | 1/4 | 8 | 6 | 14 | 11.3 | 18 | 14 | 8 | 75.6 | 19.6 | 11.5 | 25.4 | 5 | 11.5 | 3.3 |
| 2L45009 | RL45 | 3/8 | 8 | 6 | 14 | 11.3 | 22 | 17 | 9 | 77.2 | 19.6 | 11.5 | 26 | 5 | 11.5 | 3.3 |

PLUG-IN ELBOWS (R46)

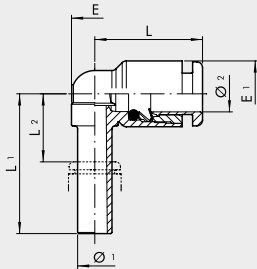

| Code | Ref. | Ø1 | Ø2 | L | L1 | L2 | E | E1 |
|---------|------|----|----|------|------|------|------|------|
| 2L46001 | RL46 | 4 | 4 | 16 | 22.5 | 8.1 | 6.8 | 9.2 |
| 2L46002 | RL46 | 6 | 6 | 18.5 | 24 | 8.4 | 8 | 11.3 |
| 2L46003 | RL46 | 8 | 8 | 21.2 | 28.5 | 11.3 | 10 | 13.8 |
| 2L46004 | RL46 | 10 | 10 | 23.3 | 32 | 13.3 | 12.5 | 16 |

EXTENDED PLUG-IN ELBOWS (R47)

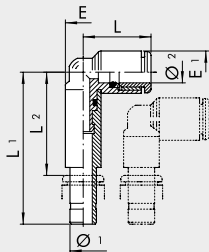

| Code | Ref. | Ø1 | Ø2 | L | L1 | L2 | E | E1 |
|---------|------|----|----|------|------|------|-----|------|
| 2L47001 | RL47 | 4 | 4 | 15.5 | 36.9 | 23.4 | 7.7 | 9.2 |
| 2L47002 | RL47 | 6 | 6 | 18.1 | 40.6 | 25.9 | 9.3 | 11.3 |
| 2L47003 | RL47 | 8 | 8 | 19.3 | 44.9 | 28.8 | 9.7 | 13.8 |

DOUBLE ELBOW (R48)

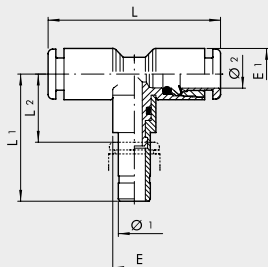

| Code | Ref. | Ø1 | Ø2 | L | L1 | L2 | E | E1 |
|---------|------|----|----|------|------|------|-----|------|
| 2L48001 | RL48 | 4 | 4 | 32 | 22.5 | 8.1 | 6.8 | 9.2 |
| 2L48002 | RL48 | 6 | 6 | 37 | 37.5 | 16.4 | 9.7 | 11.3 |
| 2L48003 | RL48 | 8 | 8 | 42.4 | 28.5 | 11.3 | 10 | 13.8 |
| 2L48004 | RL48 | 10 | 10 | 46.6 | 46 | 27.7 | 14 | 16 |

DOUBLE LATERAL ELBOW (R49)

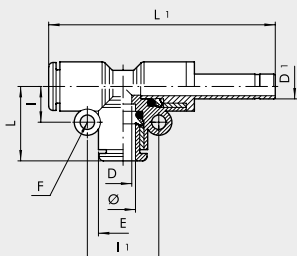

| Code | Ref. | Ø | L | L1 | I | I1 | E | D | D1 | F |
|---------|------|----|------|------|------|------|------|------|----|-----|
| 2L49001 | RL49 | 4 | 16.7 | 47.4 | 7.2 | 14.4 | 9.2 | 2.5 | 4 | 3.3 |
| 2L49003 | RL49 | 6 | 19 | 52.5 | 8.2 | 16.4 | 11.3 | 4.2 | 6 | 3.3 |
| 2L49004 | RL49 | 8 | 21.4 | 58.4 | 9.6 | 19.2 | 13.8 | 6.2 | 8 | 3.3 |
| 2L49005 | RL49 | 10 | 24.1 | 68.2 | 10.9 | 21.8 | 16 | 8.5 | 10 | 3.3 |
| 2L49006 | RL49 | 12 | 25.8 | 74.1 | 12.5 | 25 | 19.5 | 10.5 | 12 | 3.3 |

CARTRIDGES AND ACCESSORIES

BRASS CARTRIDGE WITH THREAD (R26)

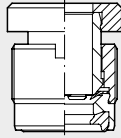

| Code | Ref. | Ø | Brace of serration on centers in plastic material [Nm] | Brace of serration on metallic centers [Nm] |
|-----------------|------|--------|-----------------------------------------------------------|------------------------------------------------|
| SERIES R | | | | |
| 2026A02 | R26 | 3 | 0.6 | 0.8 |
| 2026A01 | R26 | 3.17 ▲ | 0.6 | 0.8 |
| 2026001 | R26 | 4 ▲ | 0.8 | 1 |
| 2026002 | R26 | 5 | 0.8 | 1.5 |
| 2026003 | R26 | 6 | 0.8 | 1.2 |
| 2026004 | R26 | 8 ▲ | 1 | 1.8 |
| 2026005 | R26 | 10 | 0.8 | 2 |
| 2026006 | R26 | 12 | 0.8 | 2 |

▲ Ø3.17 = Ø1/8"; Ø4 = Ø5/32"; Ø8 = Ø5/16"

CARTRIDGE SLOT R26

Ø 3-3.17-4-6-8

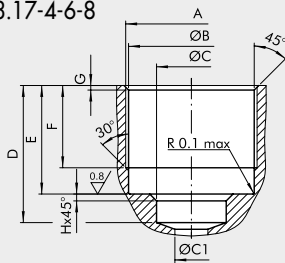

| Ø | A | ØB | ØC | ØC1 | D | E | F |
|--------|------------|----------------------------------|-----------------------------------|-------|-----------------------------------|----------------------------------------|-----------|
| 3-3.17 | M7x0.75 | 6.5 ±0.1 | 4.5 ^{+0.12} ₀ | 4 max | 10.5 ^{+0.3} ₀ | 9.5 ^{+0.1} _{-0.3} | 7 ±0.20 |
| 4 | M9.5x0.75 | 9 ^{+0.10} ₀ | 4.1 ^{-0.10} ₀ | 3 max | 12 ⁺⁰ _{-0.20} | 9.5 ^{+0.15} _{-0.05} | 7.5 ±0.20 |
| 6 | M11.5x0.75 | 11 ^{+0.10} ₀ | 6.1 ^{+0.10} ₀ | 5 max | 12 ±0.1 | 9.5 ±0.1 | 7.5 ±0.20 |
| 8 | M13.5x0.75 | 13 ^{+0.10} ₀ | 8.1 ^{+0.10} ₀ | 7 max | 15 ⁺⁰ _{-0.20} | 10.5 ^{+0.15} _{-0.05} | 8.5 ±0.20 |

| Ø | G | H |
|--------|-----|-----|
| 3-3.17 | 0.5 | - |
| 4 | 0.4 | 0.6 |
| 6 | 0.4 | 0.6 |
| 8 | 0.4 | 0.6 |

Ø 5-10-12

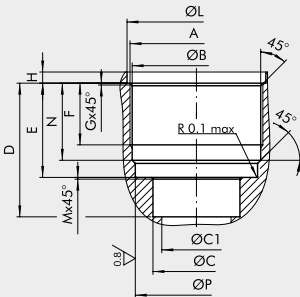

| Ø | A | ØB | ØC | ØC1 | D | E | F |
|----|------------|--------------------------------------|--------------------------------------|--------|-----------|----------------------------------|----------------------------------|
| 5 | M10.5x0.75 | 10 ^{+0.1} ₀ | 5 ^{+0.15} ₀ | 4 max | 11.8 ±0.1 | 8.9 ^{+0.1} ₀ | 5.8 ^{+0.3} ₀ |
| 10 | M15.5x0.75 | 15 ^{+0.1} ₀ | 10 ^{+0.15} ₀ | 9 max | 15.6 ±0.1 | 11 ±0.05 | 7.5 ^{+0.3} ₀ |
| 12 | M18x1 | 17.5 ^{+0.05} _{0.1} | 12 ^{+0.05} _{+0.15} | 11 max | 18 ±0.1 | 12 ±0.05 | 6.8 ^{+0.3} ₀ |

| Ø | G | H | ØL | M | N | ØP |
|----|-----|-----------------------------------|----------------------------------------|-----|---------------------------------------|------------------------------------|
| 5 | 0.3 | 0.9 ⁺⁰ _{-0.3} | 11.2 ^{+0.12} _{+0.02} | 0.1 | 7.8 ±0.05 | 9.7 ±0.05 |
| 10 | 0.3 | 1.3 ⁺⁰ _{-0.3} | 16.2 ^{+0.1} _{-0.05} | 0.2 | 9 ±0.05 | 14.9 ^{+0.10} ₀ |
| 12 | 0.6 | 1.3 ⁺⁰ _{-0.3} | 18.8 ^{+0.1} ₀ | 0.2 | 9.75 ^{+0.1} _{-0.15} | 17 ^{+0.1} ₀ |

TOOL FOR SLOT R26

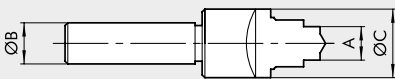

| Code | Ref. | A | ØB | ØC |
|---------|-------------------|------|----|----|
| 2025010 | UT.SE. R26 3-3.17 | 4.5 | 10 | 10 |
| 2025011 | UT.SE. R26 4 | 4.1 | 12 | 18 |
| 2025012 | UT.SE. R26 5 | 5.1 | 15 | 20 |
| 2025013 | UT.SE. R26 6 | 6.1 | 16 | 19 |
| 2025014 | UT.SE. R26 8 | 8.1 | 16 | 21 |
| 2025015 | UT.SE. R26 10 | 10.1 | 16 | 25 |
| 2025016 | UT.SE. R26 12 | 12.1 | 15 | 28 |

MALE FOR CARTRIDGE SLOT R26

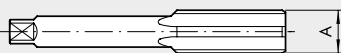

| Code | Ref. | Ø | A |
|---------|---------------|--------|------------|
| 2025020 | MA R26 3-3.17 | 3-3.17 | M7x0.75 |
| 2025021 | MA R26 4 | 4 | M9.5x0.75 |
| 2025022 | MA R26 5 | 5 | M10.5x0.75 |
| 2025023 | MA R26 6 | 6 | M11.5x0.75 |
| 2025024 | MA R26 8 | 8 | M13.5x0.75 |
| 2025025 | MA R26 10 | 10 | M15.5x0.75 |
| 2025026 | MA R26 12 | 12 | M18x1 |

BRASS COMPRESSION CARTRIDGE (R27)

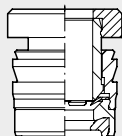

Code Ref. Ø

SERIES R

| | | |
|---------|-----|-----|
| 2027001 | R27 | 4 ▲ |
| 2027002 | R27 | 5 |
| 2027003 | R27 | 6 |
| 2027004 | R27 | 8 ▲ |
| 2027005 | R27 | 10 |
| 2027006 | R27 | 12 |

▲ Ø4 = Ø5/32"; Ø8 = Ø5/16"

CARTRIDGE SLOT R27

Ø 4-6-8

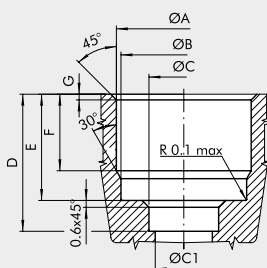

| Ø | Ø A | Ø B | Ø C | Ø C1 | D | E | F | G |
|----------------------|---------------------------------------|-----------------------------------|------------------------------------|-------|-----------------------------------|-------------------------------------|------------------------------------|-----|
| FOR ALUMINIUM | | | | | | | | |
| 4 | 9.2 ^{+0.10} _{-0.10} | 9 ^{+0.10} ₋₀ | 4.1 ^{+0.10} ₋₀ | 3 MAX | 12 ⁺⁰ _{-0.20} | 9.3 ⁺⁰ _{-0.10} | 6.7 ^{+0.10} ₋₀ | 0.5 |
| 6 | 11.3 ⁺⁰ _{-0.08} | 11 ^{+0.10} ₋₀ | 6.1 ^{+0.10} ₋₀ | 5 MAX | 12 ⁺⁰ _{-0.20} | 9.3 ⁺⁰ _{-0.10} | 6.7 ^{+0.10} ₋₀ | 0.5 |
| 8 | 13.3 ⁺⁰ _{-0.08} | 13 ^{+0.10} ₋₀ | 8.1 ^{+0.10} ₋₀ | 7 MAX | 15 ⁺⁰ _{-0.20} | 10.3 ⁺⁰ _{-0.10} | 7.7 ^{+0.10} ₋₀ | 0.5 |

| | | | | | | | | |
|--------------------------|--------------------------------------|-----------------------------------|------------------------------------|-------|-----------------------------------|-------------------------------------|------------------------------------|-----|
| FOR TECHNOPOLYMER | | | | | | | | |
| 4 | *9.2 ⁺⁰ _{-0.10} | 9 ^{+0.10} ₋₀ | 4.1 ^{+0.10} ₋₀ | 3 MAX | 12 ⁺⁰ _{-0.20} | 9.3 ⁺⁰ _{-0.10} | 6.7 ^{+0.10} ₋₀ | 0.5 |
| 6 | *11.2 ⁺⁰ _{-0.10} | 11 ^{+0.10} ₋₀ | 6.1 ^{+0.10} ₋₀ | 5 MAX | 12 ⁺⁰ _{-0.20} | 9.3 ⁺⁰ _{-0.10} | 6.7 ^{+0.10} ₋₀ | 0.5 |
| 8 | *13.2 ⁺⁰ _{-0.10} | 13 ^{+0.10} ₋₀ | 8.1 ^{+0.10} ₋₀ | 7 MAX | 15 ⁺⁰ _{-0.20} | 10.3 ⁺⁰ _{-0.10} | 7.7 ^{+0.10} ₋₀ | 0.5 |

* N.B.: the diameter in interference is purely an indication and depends on the type of plastic material used and on its thickness. We suggest you should effect practical assembling tests.

Ø 5-10-12

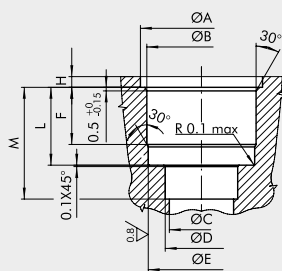

| Ø | Ø A | Ø B | Ø C | Ø D | Ø E | F | H | L | M |
|--------------------------|-------------------------------------|---------------------------------------|--------|-------------------------------------|------------|---------------------------------|-------------------------------------|-------------------------------------|------------|
| FOR TECHNOPOLYMER | | | | | | | | | |
| 5 | 12.1 ^{+0.15} ₋₀ | *10.2 ⁺⁰ _{-0.10} | 4 MAX | 5.1 ^{+0.15} ₋₀ | 9.7 ±0.05 | 6 ^{+0.2} ₋₀ | 1.2 ⁻⁰ _{-0.2} | 8.75 ⁻⁰ _{-0.1} | 11.8 ±0.10 |
| 10 | 17.1 ^{+0.15} ₋₀ | *15.15 ⁺⁰ _{-0.08} | 9 MAX | 10.15 ^{+0.1} ₋₀ | 14.9 ±0.05 | 8 ^{+0.2} ₋₀ | 1.5 ^{-0.2} _{-0.2} | 10.9 ⁻⁰ _{-0.1} | 15.6 ±0.10 |
| 12 | 19.7 ^{+0.15} ₋₀ | *17.55 ⁺⁰ _{-0.08} | 11 MAX | 12.15 ^{+0.1} ₋₀ | 17.1 ±0.05 | 9 ^{+0.2} ₋₀ | 1.5 ^{-0.2} _{-0.2} | 11.85 ⁻⁰ _{-0.1} | 18 ±0.10 |

| | | | | | | | | | |
|----------------------|-------------------------------------|-------------------------------------|--------|-------------------------------------|------------|---------------------------------|-------------------------------------|-------------------------------------|------------|
| FOR ALUMINIUM | | | | | | | | | |
| 5 | 12.1 ^{+0.15} ₋₀ | 10.3 ⁺⁰ _{-0.08} | 4 MAX | 5.1 ^{+0.15} ₋₀ | 9.7 ±0.05 | 6 ^{+0.2} ₋₀ | 1.2 ⁻⁰ _{-0.2} | 8.75 ⁻⁰ _{-0.1} | 11.8 ±0.10 |
| 10 | 17.1 ^{+0.15} ₋₀ | 15.4 ⁺⁰ _{-0.08} | 9 MAX | 10.15 ^{+0.1} ₋₀ | 14.9 ±0.05 | 8 ^{+0.2} ₋₀ | 1.5 ^{-0.2} _{-0.2} | 10.9 ⁻⁰ _{-0.1} | 15.6 ±0.10 |
| 12 | 19.7 ^{+0.15} ₋₀ | 17.8 ⁺⁰ _{-0.08} | 11 MAX | 12.15 ^{+0.1} ₋₀ | 17.1 ±0.05 | 9 ^{+0.2} ₋₀ | 1.5 ^{-0.2} _{-0.2} | 11.85 ⁻⁰ _{-0.1} | 18 ±0.10 |

* N.B.: the diameter in interference is purely an indication and depends on the type of plastic material used and on its thickness. We suggest you should effect practical assembling tests.

TOOL FOR SLOT R27

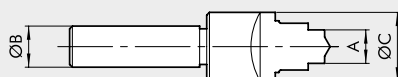

| Code | Ref. | A | Ø B | Ø C |
|--------------------------|-------------------|------|-----|------|
| FOR ALUMINIUM | | | | |
| 2027021 | UT.SE. R27 AL. 4 | 4.1 | 10 | 11.5 |
| 2027022 | UT.SE. R27 AL. 5 | 5.1 | 12 | 16 |
| 2027023 | UT.SE. R27 AL. 6 | 6.1 | 12 | 13.5 |
| 2027024 | UT.SE. R27 AL. 8 | 8.1 | 12 | 15.5 |
| 2027025 | UT.SE. R27 AL. 10 | 10.1 | 16 | 20 |
| 2027026 | UT.SE. R27 AL. 12 | 12.1 | 16 | 22 |
| FOR TECHNOPOLYMER | | | | |
| 2027011 | UT.SE. R27 P. 4 | 4.1 | 10 | 11.5 |
| 2027012 | UT.SE. R27 P. 5 | 5.1 | 12 | 16 |
| 2027013 | UT.SE. R27 P. 6 | 6.1 | 12 | 13.5 |
| 2027014 | UT.SE. R27 P. 8 | 8.1 | 12 | 15.5 |
| 2027015 | UT.SE. R27 P. 10 | 10.1 | 16 | 20 |
| 2027016 | UT.SE. R27 P. 12 | 12.1 | 16 | 22 |

R17 – DISASSEMBLY KEY

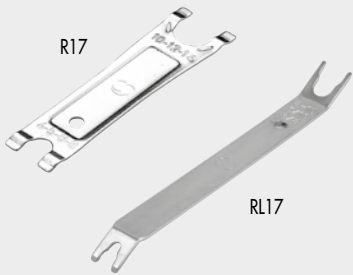

| Code | Ref. | Lenght (mm) | Ø Tube |
|---------|------|-------------|--------------|
| 2L17001 | RL17 | 140 | from 3 to 10 |
| 2017001 | R17 | 95.0 | from 4 to 14 |

R41 – CARTRIDGE KEY R26

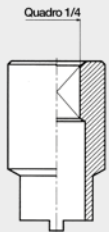

| Code | Ref. | Ø |
|---------|------|----|
| 2041001 | R41 | 4 |
| 2041002 | R41 | 5 |
| 2041003 | R41 | 6 |
| 2041004 | R41 | 8 |
| 2041005 | R41 | 10 |
| 2041006 | R41 | 12 |

NOTES